

# **TENDER DOCUMENT**

Tender No: PUCB/IT/2025/01 dated 07/08/2025

## **PROPOSED NEW DATA CENTER**

The Peoples' Urban Co-operative Bank

The Peoples' Urban Co-operative Bank Ltd  
Opp Mini Civil Station, SH15, Main Road  
Tripunithura, Ernakulam  
Kerala, India - 682 301

# Table of Contents

<b>Section 1.....</b>	<b>3</b>
<b>1. Tender Call Notice .....</b>	<b>3</b>
1.1 About PUCBL.....	3
1.2 Project Brief .....	4
1.3 Scope of Work .....	4
1.4 Detailed Scope of Work .....	4
1.5 Bill of Material (BOM) .....	6
1.6 Terms and Conditions .....	6
<b>Section 2.....</b>	<b>8</b>
<b>2. Guidance to Bidders.....</b>	<b>8</b>
2.1 Pre-Qualification criteria .....	8
2.2 Registration and Preparation of Bids .....	11
2.3 Commercial/ Financial bid .....	12
2.4 Bid Forms .....	12
2.5 Bid validity period .....	12
2.6 Bid Prices .....	12
2.7 Bid Currencies .....	12
2.8 Modification and Withdrawal of Bids .....	12
2.9 Submission of Bids .....	13
2.10 Remittance of Tender Document Fee and EMD .....	13
2.11 Corrigendum.....	15
2.12 Clarifications on Tender Documents .....	15
2.13 Opening and Evaluation of Bid .....	15
2.14 Opening and evaluation of Commercial/Financial Bid .....	15
2.15 Rejection of Bids .....	16
2.16 Award of Contract .....	16
2.17 Signing of Agreement/ Contract.....	16
2.18 Decrease or Increase in order quantity .....	16
2.19 Payment Terms .....	16
2.20 RFP Schedule .....	17
<b>Section 3.....</b>	<b>17</b>
<b>3. Special Conditions of Contract. ....</b>	<b>17</b>
3.1 Time Schedule.....	17
3.2 Call Logging Mechanism .....	17
3.3 Penalties .....	17
3.4 Upgradation .....	19
3.5 Obsolescence .....	19
3.6 Change of Model .....	19
3.7 Performance during OEM Warranty/ EXTENDED WARRANTY Period .....	19
3.8 Force Majeure .....	19
3.9 Resolution of Disputes .....	19
3.10 Applicable Law .....	20
3.11 Address for Communication .....	20
<b>Section4.....</b>	<b>20</b>
Annexure -1 .....	20
Annexure -2.....	21
Annexure -3.....	21
Annexure -4.....	24
Annexure -5.....	29
Annexure -6.....	31
Annexure -7.....	32
Annexure -8.....	68
Proposed Data Center Floor Layout .....	5

# Section 1

## 1. Tender Call Notice

The Peoples' Urban Co-operative Bank Ltd (Herein after referred to as BANK) invites e-tenders from System Integrators for Construction of new Data Center at their Head Office, Trippunithura, Ernakulam.

Bid calling date	13/08/2025
Bid closing date/time	03/09/2025@ 04.30 PM
Opening of Technical Bids date/time	08/09/2025@ 03.00 PM
Opening of Commercial Bids	12/09/2025@ 03.00 PM
Non-refundable Tender Fee	Rs 5000/- + GST
EMD	Rs 50000
Contact person	CEO, The Peoples' Urban Co-operative Bank Ltd PB No 1. H.O, Main Road, East Fort Gate, Opp Mini Civil Station, Trippunithura,Ernakulam,Kerala, India - 682301 Phone : 8714600230 Email : peoples@pucbank.com

### 1.1 About The Peoples' Urban Co-operative Bank Ltd (PUCB)

The Peoples' Urban Co-operative Bank is a licensed Urban Bank which comes under the purview of the Banking Regulation Act and controlled by the Reserve Bank of India. The registered office of the Bank is at Trippunithura, a part of the metropolitan city of COCHIN, which is known as the Queen of Arabian Sea.

The Peoples' Urban Co-operative bank started in 1917 at a central place in Trippunithura , which was then the seat of the Cochin Royal family. The institution was one of the pioneers of the co-operative movement. The main function of the Bank then was to lend money at reasonable rates of interest to the common people in order to save them from the clutches of money lenders who used to charge usurious interest and extort the common people.

The activities of the Bank in relieving the hardship of the common people, though not in large measure, earned for it a good name among the people of the locality. The credit worthiness and reputation of the Bank at that time are evident from the fact that even the Quilon National Bank, one of the leading banks in South India at that time used to deposit its surplus cash with this Bank. The reputation of this

institution and its activities had enabled it to play a worthy role in the political, Social and cultural life of the people of the locality.

## **1.2 Project Brief**

Since IT operations are crucial for bank business continuity, it requires redundant backup components and infrastructure. To cater to these requirements, The Peoples' Urban Co-operative Bank decided to construct a new Data Center for their Banking support IT Operations at their Head office, Trippunithura, Ernakulam.

## **1.3 Scope of Work**

The scope of the work extends to construction, testing and commissioning of new Data Center. This includes Supply, Installation, Testing Commissioning of Civil, Electrical, HVAC, Fire Protection & ELV Systems as per the requirement at the proposed location of Bank's Head Office, Trippunithura. Bidders should provide comprehensive warranty of 3 years and maintenance support for a period of 2 years.

## **1.4 Detailed Scope of Work**

The scope of work of the bidder includes Supply, Installation, Testing and Commissioning of Physical Infrastructure comprising Civil, Electrical, HVAC, Fire Protection, ELV & Plumbing works etc to build a Data Center as per layout specified in Annexure-10

Supply and Installation of

- Fire rated partitions
- Doors
- False Flooring
- False Ceiling
- Vitrified Flooring
- Vinyl Flooring
- Floor & Ceiling Insulation
- Access Ramp
- Painting & Finishing
- Electrical Panels & DB's
- Electrical cables
- Earth Pits and Earth Distribution
- Cable & Network Trays
- Lighting System
- Switches and Sockets
- UPS & Batteries
- Precision AC System
- Precision AC Low Side Works
- Hi-wall Spit AC System
- Hi-wall Spit AC Low Side Works
- IT Rack & Accessories
- Fire Detection & Suppression system
- Water Leakage detection system
- Rodent Repellant

- CCTV surveillance systems
- Access Control systems

Provide Comprehensive Onsite Warranty for all hardware and software components during the warranty period of 3 years. Should install software updates and patches as and when released, during the warranty period.

The bidder should offer necessary training for staff on operation of the equipment and ongoing management for the equipment supplied. Provide complete documentation including Layout Diagrams, GA Drawings, SOP, Operation Manuals, Material Specifications, Technical Data Sheets, Test Certificates etc as applicable of the items supplied.

## Proposed Data Center Floor Layout

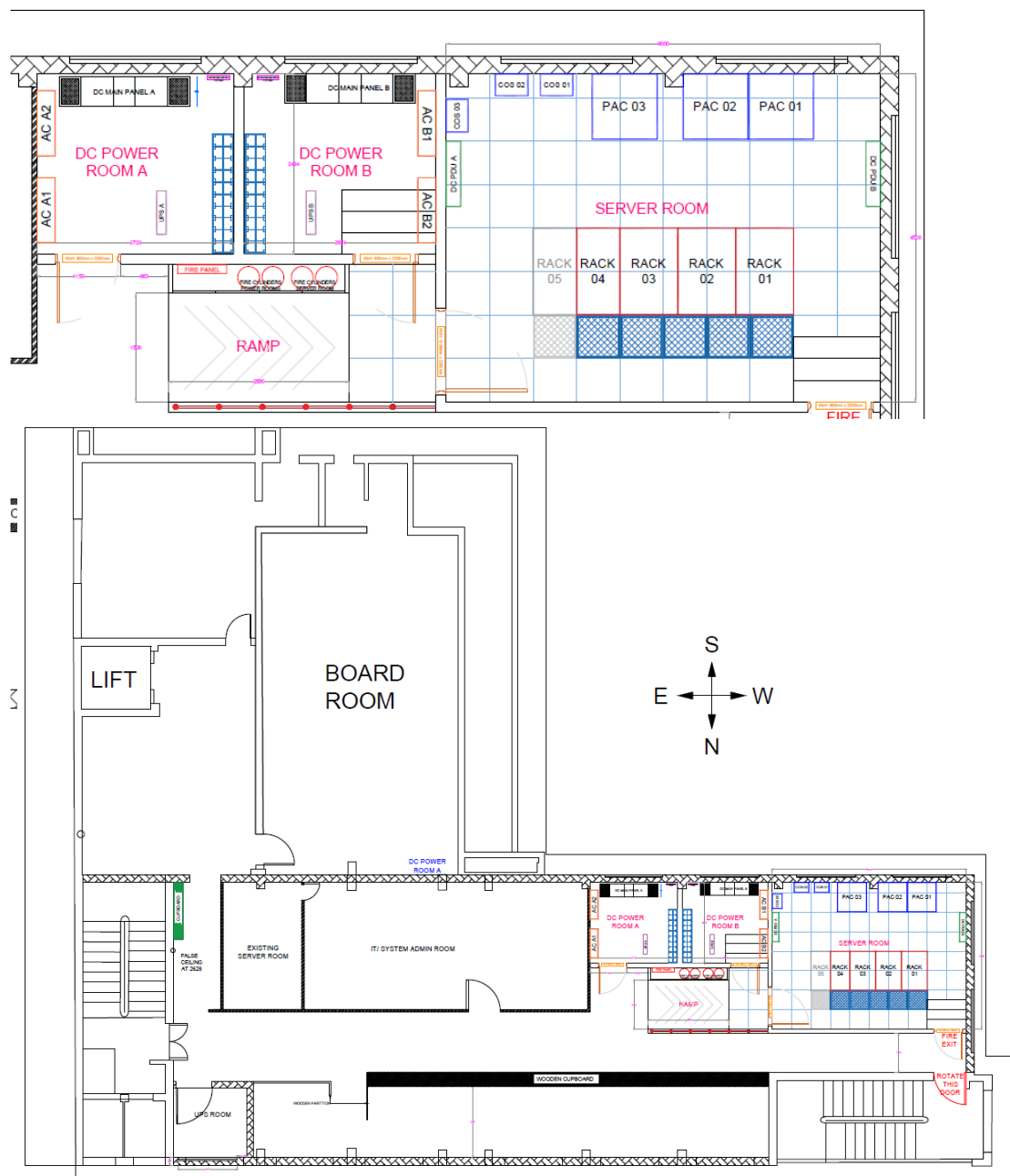

### **1.5 Bill of Material (BOM)**

The bidder shall supply and install the following Items as per Technical Specification and the required quantity mentioned in the **Annexure 9** (Total BOM Pricing Schedule\_Rev 0.0\_20250305.xlsx)

The bidder shall comply all the materials specifications and preferred makes as per mentioned in **Annexure 7** (Unpriced Detailed Bill of Materials /Technical Specifications /Compliance) and **Annexure 8** (Approved Make of Materials /Compliance).

### **1.6 Terms and Conditions**

1. Supply and installation of items and their related accessories mentioned as per the BOM.
2. Bidder must do site study furnish downtime requirements, design document, dependencies if any, along with detailed work schedule with in two weeks of receipt of work order.
3. The selected bidder needs to ensure that proposed solution /devices /infrastructure is of latest configuration and not declared End of Life by the OEM.
4. The solution offered should have the capability of implementing and supporting all latest Data Center standards and should be future-ready to adopt integration with prevailing international standards.
5. If, during the warranty period, any of the supplied equipment fails to function properly due to any reason except force majeure event or if the equipment has been repaired four or more times in a quarter, the bidder shall arrange replacement of the same by new equipment of equivalent or higher configuration, at no cost to end user.
6. The selected bidder should inform the name of the project manager /coordinator who would be the single point of contact during the complete project implementation.
7. The bidder shall provide detailed as-built drawing of the installed setup after completion of the project. This will also include the printout /soft copies of important configuration settings /credentials of the Data center equipment.
8. The selected bidder shall relocate and reinstall one of the existing 6kVA UPS located at present Server Room to one of the new DC Power Room as per consultant.
9. The selected bidder will be responsible for proactively monitoring overall health of the implemented solution during the warranty period. The associated engineer is required to visit onsite on Quarterly basis to proactively check for any issues in Data Center infrastructure and its capability during the warranty period. Bidder shall be responsible for arranging for resolution of issues, if any, during the period.
10. The System Integrator/ bidder shall arrange all the equipment, machinery etc required for the work for which no extra charges will be paid.
11. The rate shall be inclusive of all loading, unloading and transportation of the materials to work site.

12. Repair to all types of damaged brick / brick tile / stone masonry work in superstructure / substructure and reconstructing to match existing pattern should be undertaken by the bidder.
13. Bidders shall provide 3 years of warranty for all the equipment /services offered by them inclusive of installation items and hardware.
14. Work may be required to carry during off hours, extended hours or during holidays based on comfort and convenience of the location if required.
15. Store the supplied items in a clean and dry space, maintain factory protection or cover them with heavy canvas or plastic to keep out dirt, water, construction debris and dust. (Heat enclosures are to be provided to prevent condensation). Handle in accordance with the manufacturer's written instructions to avoid damaging equipment, installed devices and finish.
16. Inspection of all the materials, equipment etc. immediately on commencement of work at site/receipt of equipment at site, whichever is earlier, and reporting of any defect /damage /discrepancy /shortage to the Owner /Consultant within seven days for necessary action.
17. All debris /leftovers should be removed and premises kept clean after completion of work.
18. Work man ship provided by the contractor should be skilled enough to carry out all the works for the better and efficient execution of works. In case of deficiency in services, BANK reserves the right to deduct payment in the final settlement of payment.
19. Safety: Material and labour safety will be solely responsibility of the bidder.
20. Post completion of work, there will be 2 weeks of observation period before acceptance of the complete work.
21. Measurements: Measurements will be made jointly, and payment will be made as per the actual measurements only. For civil work, the finished and visible area will be measured. Whereas the electrical wiring items whichever will get concealed should be measured before getting concealed.
22. Bidder must submit the actual measurement sheet in the prescribed format along with the invoice.
23. The vendor shall plan various activities and submit the execution schedule within two weeks from awarding the work. The execution schedule should clearly indicate all activities and the time required for completion of each activity taking the total project time of 20 weeks. The project shall be closely monitored with respect to this schedule. The physical progress of the work shall be monitored from time to time and reviewed in the Weekly Progress Review Meetings to be held as agreed between both the parties.
24. Rates quoted should be inclusive of all cost of materials, tools /equipment /labour charges, conveyance to site, handling charges, loading and unloading charges, hiring charges, clearing of debris, statutory payments, all taxes etc complete.

25. The bidder must visit the work site and get acquainted with all the information required before submitting the tender. The bidder needs to study the site, collect the required information and understand all the site conditions for completing the work in the prescribed time-period. No extra claim on account of any extra work required after submission of tender will be entertained
26. The materials used should be as per specification and of good quality
27. During the execution of work the bidder or authorized representative should be present at site.
28. The work should be carried out without causing any inconvenience to the employees. Vendor should ensure that no damage is caused to the existing site premises.
29. All Materials, Equipment's /Tools required for the work should be arranged by the bidder and brought to site for the timely completion of the work.
30. The bidder must arrange necessary insurance coverage for the machine, workmen etc. deployed by him. He shall arrange all safety measures to protect his workmen and the properties of proposed location.
31. Acceptance report needs to be collected from the end user after the testing and commissioning of the whole project. The Warranty starts from the date of acceptance for the full project.

## **Section 2**

### **2. Guidance to Bidders**

This tender is an offline tender invited in two cover formats (Technical bid and financial bid) from System Integrator or bidder for the construction of Data Center of The Peoples' Urban Co-operative bank which includes Supply, Installation commissioning and warranty support of 3 years for the items supplied.

Bidders are advised to study the tender document carefully. Submission of bids shall be deemed to have been done after careful study and examination of the tender document, its annexure and any subsequent corrigendum, if any, with full understanding of its implications. The interested SI/bidders should submit their bids in compliance with the Tender procedures and Contract terms as prescribed in the Tender Document.

#### **2.1 Pre-Qualification criteria**

Important Note: For all the below-mentioned eligibility criteria, the experience or turnover of OEM shall not be considered as bidder's experience or turnover if the OEM is not directly the bidder for this tender.



Sl. No	Eligibility Criteria	Documents to be submitted
1	Bidder should be a company registered in India under the Companies Act,1956, since last 10 Years/Proprietary firms/partnership firms	Copy of Certificate of Incorporation/Registration under companies Act,1956/2013, GST Certificate
2	The bidder shall be an OEM of Major equipment's like UPS, PACs, DCIM and Server Racks or Authorized partner/bidder of the OEM of Major equipment's like UPS, PACs, DCIM and Server Racks.. Consortium and joint ventures formed for the purpose of this project are not eligible to bid	OEM Business Partner Letter
3	The Bidder's Annual turnover shall be more than Rs.5 Crore each, during 3 financial years 2022-23,2023-24 & 2024-25	Audited and certified copies of balance sheet and profit/loss Account Statement to be provided for the last three financial years
4	The Bidder should have valid Electrical Contract license not less than class B issued by Kerala State Electrical Inspectorate and should have own Supervisor License and CPWD Enlistment Certificate- not less than Class III Composite category	1.Electrical Contract License (not less than Class B) issued by the Kerala State Electrical Inspectorate. 2.Electrical Supervisor License issued by the Keral State Electrical Inspectorate. 3. CPWD Enlistment Order ( not less than Class III Composite
5	The bidder shall have an office/service center in Kochi/Ernakulam, with qualified support staff and full fledged service facility	office address details with valid Government document supporting the same
6	The Bidder shall not have been debarred / declared ineligible for corrupt or fraudulent practices or blacklisted with any of the Government Authority in India	Declaration in the regard by the authorized signatory of the bidder.
7	The Bidder shall have direct purchase and support agreement with the OEMs of Data center Equipment's.	OEM Authorization Letter
		Confirm that the products/technologies/components /services quoted are not end-of-life
8	The bidder should have at least 5 years' experience in the datacenter field.	The copy of Purchase Order showing proof of date should be attached along with technical bid

9	Bidder should have experience of having successfully supplied, installed commissioned and maintained at least two Data Centre Infrastructure project for any Government BANK, PSUs etc.	1)Minimum one Data Centre infrastructure Project implemented in Kerala each costing not less than 50 Lakhs in a single order ( Copy of Purchase Order and work Completion certificate of the client)
		2)Two Data Centre infrastructure Project implemented in Kerala each costing not less than the amount of Rs.25 Lacs each (Copy of Purchase Order and work Completion certificate of the client)
10	The Bidder should be a Certified Data Centre Professional	Copy of CDCP certificate should be provided
11	The bidder must carry out the installation and commissioning of all the supplied hardware components and software components and it must be done by OEM /Trained Engineers	Copy of Factory Training Certificate should be provided
12	The bidder should have an ISO 9001-2015 certifications and, ISO 27001:2022,ISO 20000-1:2018 for IT related works	Copies of valid ISO certificates
13	<b>Proof of payment of Tender Fee and Earnest Money Deposit</b>	Copy required
14	The bidder should Submit Bidder Profile	As per Annexure 1
15	The bidder should Submit Bank Guarantee for Contract Performance (To be stamped in accordance with Stamp Act) (The non-judicial stamp paper should be in the name of issuing Bank)	As per Annexure 2
16	The bidder should Submit Agreement On Rs. 200/- Non-Judicial Stamp Paper	As per Annexure 3
17	The bidder should Submit Bid form (To be submitted in Letter Head)	As per Annexure 4
18	The bidder should Submit the Manufacturer Authorization Form (MAF)	As per Annexure 5

	(This letter of authority shall be on the letterhead of the manufacturer and shall be signed by a person competent and having the power of attorney to bind the manufacturer.)	
19	The bidder should Submit the Response to Tender: Technical bid.	As per annexure 6
20	The bidder should Submit Technical specification compliance sheet clearly mentioning any deviations from the required specifications (Unpriced Detailed Bill of Materials/Technical Specifications /Compliance)	As per Annexure 7.
21	The bidder should Submit Approved Makes of material compliance sheet clearly mentioning any deviations from the required specifications	As per Annexure 8.
22	The bidder should Submit Financial Bid in attached Bill of Materials in MS Excel format.	As per Annexure 9

## 2.2 Registration and Preparation of Bids

Documents comprising the bid

The bid prepared by the Bidder shall comprise of the following components:

### *Pre-Qualification cum Technical Bid*

The Technical Bid should consist of the following towards pre-qualification evaluation:

- Submit relevant documents against all Pre-Qualification criteria 2.1
- Submit relevant datasheets of the make & model number of the offered product needs to be uploaded.
- Submit Technical specification compliance sheet clearly mentioning any deviations from the required specifications
- A soft copy of the same must be submitted via email

## **2.3 Commercial/ Financial bid**

Bidder shall quote his prices in the excel sheet provided along with the tender document. Bidder shall not make any changes in the excel sheet except for entering the rates as per rows and columns provided. In case of any changes at cells other than designated, bidder's price bid is liable to be rejected. Bidders shall submit price bid by entering prices for each specific product separately. In case this requirement is not fulfilled, bidder's price bid is liable to be rejected.

## **2.4 Bid Forms**

Wherever a specific form is prescribed in the bid document, the bidder shall use the form to provide relevant information. If the form does not provide sufficient space for any required information, space at the end of the form or additional sheets shall be used to convey the said information.

## **2.5 Bid validity period**

All bids shall be valid for a period of 6 months from the date of opening of the financial bid during which period or till the tenders are decided, whichever is earlier, bidder will not be free to withdraw the submitted bid. Any such withdrawal will entail forfeiture of the earnest money deposited against this tender.

Due to administrative reasons if it is found necessary to keep the tender open for a further period, prior consent of the bidder shall be obtained in writing.

## **2.6 Bid Prices**

The Bidder should offer prices as follows:

- I. The bidder shall quote a fixed price for each item. A Bid submitted with an adjustable price quotation or conditional Bid may be rejected as non-responsive.
- II. No adjustment of the contract price shall be made on account of any variations in future during the contract period.
- III. The Contract price shall be the only payment, payable by the BANK to the successful bidder for completion of the contractual obligations under the Contract and subject to prevailing rules.
- IV. The price would be inclusive of all packing, forwarding, freight, delivery, loading & unloading, assembling etc. All taxes/ levies shall be shown separately in respective columns provided in price bid. Any column left blank would be construed as not quoted.
- V. The supplier shall quote as per the prescribed BOM for all the items given in the price bid (Annexure 9).

## **2.7 Bid Currencies**

The prices shall be quoted in Indian Rupees only.

## **2.8 Modification and Withdrawal of Bids**

- The Bidder is allowed to modify or withdraw his submitted bid any time prior to the last date & time prescribed for submission/ receipt of bids.

- No modification & withdrawal of bids is allowed after the last date for receipt of bids, till bid validity period. Any such requests will result in the forfeiture of its EMD from the Bidder.

## **2.9 Submission of Bids**

The bidder shall submit the bid documents (as per format specified in tender) well in advance before the prescribed date & time. A soft copy should also be submitted via email.

Tender document fees and Earnest Money Deposit (EMD)

- a) Rs. 5000/- + GST, is fixed as tender document fee.
- b) Rs. 50000/- fixed as Earnest Money Deposit (EMD).
- c) Bidder shall submit/ remit EMD along with tender fee as a single transaction & non- submission of sufficient EMD/ tender fee shall be one of the primary reasons for rejection of the offer in the first round.
- d) Bidders exempted from submission of EMD may avail the facility as per prevailing rules, subject to submission/ uploading of valid documents
- e) None of the bidders other than those specified in above clause are exempted from the remittance of EMD, in any case.
- f) EMD of unsuccessful bidder will be refunded promptly through online transfer, after completion of the respective tendering stage and as per rules
- g) The successful bidder's EMD will be refunded once the selected bidder executes the agreement along with furnishing of performance security as per tender conditions.
- h) No interest will be paid for the EMD submitted under any circumstances.
- i) The EMD will be forfeited, if a bidder;
  1. Misrepresents facts or submit fabricated / forged / tempered / altered / manipulated documents during verification of tender process.
  2. Withdraws its bid after last date and time of closing the bid.
  3. A successful bidder fails to sign the contract after issuance of Letter of Intent.
  4. Fails to furnish performance security after issuance of Letter of Intent/ Work order.

## **2.10 Remittance of Tender Document Fee and EMD**

Bidders can pay the Tender Document Fees and Earnest Money Deposit (EMD) through any of the following modes:

### **A. Online Payment Options**

1. NEFT (National Electronic Fund Transfer) / RTGS (Real Time Gross Settlement)

- Bidders can transfer the combined amount of Tender Fee and EMD through NEFT or RTGS from any bank.
- The transfer must be made to the following account:
  - Account Name: **THE PEOPLE'S URBAN CO-OPERATIVE BANK LIMITED**
  - Account Number: **0341102000001717**
  - Bank Name & Branch: **IDBI BANK,THRIPUNITHURA BRANCH**
  - IFSC Code: **IBKL0000341**
- After completing the transaction, bidders must:
  - Ensure they note down the UTR number or transaction ID
  - Submit the payment confirmation receipt or UTR number during bid submission
  - Mention the same in the covering letter/documentation as proof of payment

#### **Timing Recommendations:**

- NEFT: Initiate at least 48 hours before bid closing time.
- RTGS: Initiate at least 24 hours before bid closing time (due to RBI cutoff timings).

### **B. Offline Payment Options**

#### **1. Demand Draft (DD) / Pay Order**

- Bidders may also pay via a Demand Draft or Pay Order issued by any Scheduled Commercial Bank.
- The DD/Pay Order must be:
  - In favor of: **The Peoples' Urban Co-operative Bank Ltd**
  - Payable at: **All The Peoples' Urban Co-operative Bank Ltd Branches**
  - Cover the total amount of Tender Fee and EMD
- The original instrument must be submitted in a sealed cover to the address mentioned in the tender before the bid submission deadline.
- A scanned copy must be submitted during online bid submission.

#### **2. Cash Payment**

- Cash payments can be made at any of the The Peoples' Urban Co-operative Bank Branch counters.
- A copy of this payment receipt must be provided during bid submission.

### **General Instructions**

- Bidders must ensure that the entire amount (Tender Fee + EMD) is paid in a single payment, regardless of the payment mode.
- Any transaction charges are to be borne by the bidder.
- Bids with incomplete or failed payments will be rejected.

- Payments received after the bid submission deadline will not be considered, and such bids will be disqualified.
- The bid will be considered for evaluation only if the payment status is clear and verifiable at the time of bid opening.

### 2.11 Corrigendum

All corrigendum to this tender shall be issued/ published online under “Tender” section of [www.pucbank.com](http://www.pucbank.com) website. Bidders are advised to check the status regularly for getting tender updates and submitting the bid accordingly.

### 2.12 Clarifications on Tender Documents

A prospective Bidder requiring any clarification on the RFP Document may submit his queries, in writing, at the mailing address and as per schedule indicated in “Invitation for Bids / Key Events and Dates”. The queries must be submitted in the following format only to be considered for clarification:

Sl. No.	Document Name.	Reference No.	Subject	Clarification Sought

The queries not adhering to the above-mentioned format will not be responded.

BANK will respond to any request for clarification to queries on the Tender Document, received not later than the dates prescribed in Invitation for Bids / Key events and dates.

### 2.13 Opening and Evaluation of Bid

Opening and Evaluation of Pre-Qualification cum Technical Bids

- a) Bid opening shall be done as per the date mentioned in critical dates section of the tender document.
- b) To assist in evaluation and comparison of bids the BANK, at its discretion, may seek clarification from bidder. However, no post bid clarification/confirmation of compliance at the initiative of the bidder shall be entertained.
- c) The BANK shall evaluate in detail the Pre-qualification cum Technical Bids against the conditions /specifications stipulated in the tender document and determine whether the bid complies with stipulated requirements. Only technically successful bids will be considered for Commercial/ financial Bid opening.

### 2.14 Opening and evaluation of Commercial/Financial Bid

- i. Commercial/ financial bid of only technically qualified bids will be opened for evaluation.
- ii. The total cost of equipment and amount quoted for Warranty shall be taken to arrive at the L1 bidder.

BANK at its discretion may re-tender or cancel the tender at any stage without assigning any specific reason thereof.

#### **2.15 Rejection of Bids**

BANK reserves the right to reject any bid or re-tender or cancel the complete tender at any stage of tender process without assigning any specific reason thereof.

#### **2.16 Award of Contract**

The contract shall be awarded to the lowest bidder (L1 bidder). The acceptance of the tender will be intimated to the successful bidder by BANK through E-mail/ Fax / by Post.

Performance Bank Guarantee (PBG)/ Security Deposit

The selected bidder shall submit the Performance Bank Guarantee (PBG) equivalent to 5% of the contract amount. The PBG format is provided in Annexure - 2. The PBG shall have a validity of warranty period + 4 months over & above the actual date of agreement.

#### **2.17 Signing of Agreement/ Contract**

Along with submission of PBG, the selected bidder shall execute an Agreement /contract with the BANK, within 10 days from receipt of work order, in the prescribed form attached in Annexure - 3. The bidder will be rejected along with forfeiture of EMD, if agreement is not executed as per above schedule and work will be awarded to the next lowest bidder, as per rules.

#### **2.18 Decrease or Increase in order quantity**

BANK reserves the right to decrease the quantity of equipment while placing the work order depending on requirements at proposed site conditions. BANK has the right to order additional quantity of upto 30 % of the total quantity placed through original Work order/Letter of Intent at any time during the contract. The selected supplier is bound to deliver the requested quantity at the contract price

#### **2.19 Payment Terms**

Payment shall be made to the selected Bidder as per the following schedule:

1. 75% payment will be released on delivery of the infrastructure /equipment mentioned in scope of work/BoM
2. 20% will be released after installation /commissioning and acceptance test conducted in presence of the BANK official(s), End user and its nominated consultant(s).
3. 5% will be released on half yearly basis (during the warranty period) in equal proportion after deducting the SLA penalties, if any, and submission of Quarterly preventive maintenance reports for that half.



## **2.20 RFP Schedule**

The tender schedule shall be governed by the dates mentioned in the tender publication

# **Section 3**

## **3. Special Conditions of Contract.**

### **3.1 Time Schedule**

Supply, installation and configuration of all components at indicated sites shall be completed within 20 weeks from the date of issue of Work order. BANK may at its sole discretion, allow bidder additional time for completion of the work. The grace period will not be granted if the extension is necessitated due to the default on part of the bidder.

### **3.2 Call Logging Mechanism**

The vendor shall provide a call logging mechanism which takes care of entire incident and problem management. In the event of incident / Complaint during the warranty period the BANK should be able to log an issue call in the system through Toll- free helpline/ web portal/ e-mail, etc.

### **3.3 Penalties**

If the supply and installation are not completed in all respects as per the defined scope within 20 weeks from the date of work order, penalty will be levied as follows:

- i. In case of late delivery of equipment /solution, the bidder will be liable to 1% of the value of undelivered / Uninstalled portion of the order value for every week of delay beyond the scheduled delivery date by way of liquidated damages. Cap on liquidated damages shall be 10% of the undelivered /uninstalled value of the order.
- ii. In case of any problem with the solution and/or systems (Hardware & Software) during its AMC/support/warranty period post installation, it should be rectified within 48 hours from the time of reporting or arrange a standby to maintain the business continuity. Failure to do so will attract penalty of 0.5% per day of the cost of the equipment subject to maximum of 10% of the cost of the equipment.
- iii. Down time due to following situations will not be considered for the purpose of penalty calculation:
  1. Scheduled maintenance by the SI/bidder with prior intimation to end user
  2. Force majeure events including on site power failures.

### **3.4 Upgradation**

- a) The successful bidder shall ensure availability of upgraded versions of firmware /software /components to the BANK free of cost during the warranty period
- b) The software upgrades /patches applicable during the OEM warranty and EXTENDED WARRANTY period shall be provided free of cost.

### **3.5 Obsolescence**

- a) The bidder shall guarantee that the equipment's quoted and supplied shall not be obsolete or proclaimed as 'End of Life' by the Original Equipment Manufacturer during the warranty period/ extended warranty period.
- b) The bidder should guarantee that the equipment's shall be supported with necessary spares and technical support by the Original Equipment Manufacturer for 5 years. Bidder shall produce OEM certificate to this effect.

### **3.6 Change of Model**

No change of model after the placement of order shall be entertained unless the alternate model offered competent authority has been obtained in writing for such change of model before the delivery of the product. Delivery of the alternate product without such approval shall not be accepted and the BANK shall not be responsible for any delay in delivery schedule on this account.

### **3.7 Performance during OEM Warranty/ EXTENDED WARRANTY Period**

During the Warranty period, if the supplier fails to repair/ replace the equipment supplied, within the SLA as defined in this document, the BANK/end user reserves to replace the components/ product with new ones at the Bidder's cost. All costs for such replacements shall be made by forfeiting the Performance Bank Guarantee of the supplier or payments due to supplier.

### **3.8 Force Majeure**

Neither Vendor nor BANK shall be liable for any delay in or failure of discharging respective obligations under this tender caused by occurrence beyond their control, as the case may be, including but not limited to fires, floods, explosions, power shortage, acts of GOD, hostility, act of public enemy, wars, insurrections, riots, strikes, lockouts, sabotage. Either parties shall promptly but not later than 10 days of commencement there of notifying the order in writing of such contingency and prove that such is beyond control and affects the implementation of this tender condition adversely and materially. If such contingency continues beyond 30 days both parties agree to discuss and agree upon an equitable solution.

### **3.9 Resolution of Disputes**

The BANK (Purchaser) and the supplier shall make every effort to resolve amicably by direct informal negotiation any disagreement or dispute arising between them or in connection with the contract. If, after thirty (30) days, the parties have failed to resolve their dispute by such mutual consultation, then such disputes shall be referred to Legal Advisors shall be binding on both parties.

### **3.10 Applicable Law**

The contract shall be governed and interpreted in accordance with the applicable laws of India. Only the courts at Ernakulam, Kerala shall have exclusive jurisdiction to entertain matters arising out of this contract. The parties shall continue to perform their respective obligations under the Contract unless they otherwise agree.

### **3.11 Address for Communication**

CEO,  
The Peoples' Urban Co-operative Bank Ltd  
PB No 1. H.O, Main Road, East Fort Gate, Opp Mini Civil Station,  
Tripunithura, Ernakulam, Kerala, India - 682301  
Phone : 8714600230  
Email : peoples@pucbank.com

## **Section 4.**

### **Annexure -1**

## BIDDER PROFILE

1	Name	
2	Address	
3	Telephone & Fax	
4	Email &Website	
Details of Authorized Person		
5	Name	
6	Address	
7	Telephone &Email	
Information About the Company		
8	Status of company (Public Ltd/Pvt. Ltd)	
9	Details of Registration of Firm	
10	Number of Professionals	
11	Location and Address of Offices (in India and Overseas, if any)	
12	Service Tax Registration Number	
13	Income Tax Registration Number	
14	GST Registration Number	

Signature of the Bidder

## Annexure -2

### **BANK GUARANTEE FOR CONTRACT PERFORMANCE**

(To be stamped in accordance with Stamp Act) (The non-judicial stamp paper should be in the name of issuing Bank)

Ref : Tender No. . xxxxxxxxxxxxxxxxxxxxxxxxxxxxxxxxxxxx

Bank Guarantee No

Date

To

The Peoples' Urban Co-operative Bank Ltd  
PB No 1. H.O, Main Road, East Fort Gate, Opp Mini Civil Station,  
Tripunithura, Ernakulam, Kerala, India - 682301  
Phone : 8714600230  
Email : peoples@pucbank.com

Dear Sir,

In consideration of the The Peoples' Urban Co-operative Bank LTD (hereinafter referred to as the Owner", which expression shall unless repugnant to the context or meaning thereof include its successors, administrators and assigns) having awarded to M/s\_\_\_\_\_, a contract. Bearing No \_\_\_\_\_ date\_\_\_\_\_ valued at \_\_\_\_ for\_\_\_ and the contractor having (scope of contract) agreed to provide a Contract Performance of the entire Contract equivalent to (5 per cent) of the said value of the Contract to the Owner. We at \_\_\_\_\_ (hereinafter referred to as the 'BANK', which expression shall, unless repugnant to the context or meaning thereof, include the successors, administrators, executors and assigns) do hereby guarantee and undertake to pay the Owner, on demand any and all money payable by the Contractor to the extent of \_\_\_\_\_ as aforesaid at any time up to (day/month/year) without any demur, reservation, contest, recourse or protest and/or without any reference to the Contractor. Any such demand made by the owner the Bank shall be conclusive and binding notwithstanding any difference between the owner and contractor or any dispute pending before any court, tribunal or any authority.

The Bank undertakes not to revoke this guarantee during its currency without previous consent of the Owner and further agrees that the guarantee herein contained shall continue to be enforceable till the Owner discharges this guarantee. The Owner shall have the fullest liberty, without affecting in any way the liability of the Bank under this guarantee, to postpone from time to time the exercise of any powers vested in them or of any right which they might have against the Contractor, And to exercise the same at any time in any manner, and either to enforce or to forebear to enforce any covenants, contained or implied, in the Contract between the Owner and the Contractor or any other course of or remedy or security available to the Owner. The Bank shall not be released of its obligations under these presents by any exercise by the Owner or by any other matters or thing whatsoever which under law would, but for this provision, have the effect of relieving the Bank. The Bank also agrees that the Owner at its option shall be entitled to

enforce this Guarantee against the Bank as a principal debtor, in the first instance without proceeding against the Contractor and notwithstanding any security or other guarantee that the Owner may have in relation to the Contractors liabilities.

The performance guarantee shall also govern the following guarantees

- a. The Hardware / Software supplied under the contract by the Contractor shall be free from all defects / bugs and upon written notice from BANK, the Contractor shall fully remedy, free of expenses to BANK, all such defects / bug as developed under the normal use of the said hardware / software within the period of guarantee/Warranty.
- b. The performance guarantee is intended to secure the performance of the entire system. However, it is not to be construed as limiting the damages stipulated in any other clause of tender Notwithstanding anything mentioned herein above our liability under this guarantee is restricted to Rs. \_\_\_\_\_ and it shall remain in force up to and including \_\_\_\_\_ and shall be from time to time for such period (not exceeding one year), as may be desired by M/s \_ on whose behalf this guarantee has been given extended.

WITNESS

Dated this \_\_\_\_\_ day of \_\_\_\_\_ 2025 at \_\_\_\_\_

Signature \_\_\_\_\_ Signature \_\_\_\_\_

Name \_\_\_\_\_ ( Bank's Rubber Stamp)

Official address \_\_\_\_\_ Name \_\_\_\_\_

Designation with Bank Stamp

Attorney as per Power of Attorney No.  
Date

## Annexure -3

On Rs. 200/- Non-Judicial Stamp Paper

### AGREEMENT

This agreement is made at \_\_\_\_\_ on the \_\_\_\_\_ Month of \_\_\_\_\_ between, The Peoples' Urban Co-operative Bank Ltd, PB No 1. H.O, Main Road, East Fort Gate, Opp Mini Civil Station, Tripunithura, Ernakulam, Kerala, India - 682301 India which expression shall, wherever the context so permits and includes its successors and assigns) herein after referred as "BANK") of the one part, and \_\_\_\_\_ with its registered office at \_\_\_\_\_ represented by Shri/Smt. \_\_\_\_\_ (name and address of the supplier) (Hereinafter referred to as "the supplier") of the other part.

Whereas the Bank has invited a tender vide tender number. \_\_\_\_\_ dated \_\_\_\_\_ for the construction of the datacenter as per the schedule given therein.

WHEREAS the supplier hereinabove has submitted specific proposals in response to the above tender to undertake the Supply, Installation, Testing and Commissioning of DATA CENTER

WHEREAS the Bank has, after tendering and evaluation of samples, accepted the rates for the supply and installation of hardware and accessories

1. The Supplier hereby declares that the goods sold to under this contract shall be of the best quality and workmanship and shall be strictly in accordance with the specifications and particulars contained in the Purchase Order attached herewith and supplier hereby guarantees that the said goods would continue to conform to the description and quality aforesaid for a period of 20 months from the date of delivery of the said goods to and that notwithstanding the fact that may have inspected or approved the said goods, if during the aforesaid period of 20 months the said goods be discovered not to conform to the description and quality aforesaid or have deteriorated (and the decision of the BANK in that behalf will be final and conclusive) will be entitled to reject the said goods or such portion thereof as may be discovered not to conform to the said description and quality. On such rejection the goods will be at the supplier's risk and all the provisions herein contained relating to rejection of goods, etc, shall apply. The supplier shall, if so called upon to do replace goods, etc. or such portion thereof as is rejected by the BANK. Otherwise, the supplier shall pay to such damages as may arise by reason of the breach of the condition herein contained. Nothing herein contained shall prejudice any other right of in that behalf under this contract or otherwise.
2. Requests for enhancement of rates once accepted will not be considered except where have prior to the actual supplies, expressly agreed in writing for any price variation under specified circumstances. Conditions of sale or other special terms and conditions, if any, printed on the quotation sheets of the Supplier or attached with the supplier's tender or any other letter or paper from the supplier will not govern this contract nor bind the BANK in any manner whatsoever unless such terms have been expressly accepted by in writing.
3. The articles and quantities to be supplied are shown in the Purchase Order attached herewith. The Supplier agrees to supply the quantities of the articles shown in the order at



the rate tendered by him for each article within four weeks from the date of receipt of the order.

4. The supplier agrees that time is the essence of this contract.
5. If the supplier defaults in the due supply of all or any of the articles correctly and promptly as above, are at liberty to procure the same from elsewhere without cancelling the contract as a whole. If incur, in thus procuring such materials, a higher cost than the agreed rate such excess cost may be deducted by the Supplier's bill or adjusted or otherwise realized from his security deposit or recovered from him by other means. The Supplier agrees that he shall not be entitled to claim the excess, if any, of the tendered rate over such cost to BANK.

(b) If the Supplier fails to deliver all or any of the item or perform the service within the time/period specified in the

contract, the BANK shall without prejudice to its other remedies under the contract, deduct from the contract price as liquidated damages, a sum equivalent to 1% of the delivered price for the delayed stores or unperformed services for each week of delay until actual delivery or performance, up to a maximum deduction of 10% of the contract price of the delayed stores or services. Once the maximum is reached, the BANK may consider termination of the contract at the risk and cost of the contractor.

6. All payments to the Supplier for supplies affected satisfactorily will be made after scrutiny of Invoices. The supplier shall produce Original Invoice in Form No. 8/8A, Delivery Challans & Installation Certificates duly acknowledged by the customer within 15 days after the successful installation.
7. The Supplier shall not assign or make over in part or wholly the contract or the benefits or burdens thereof. The Supplier shall not underlet or sublet the execution of the contract or any part thereof without the consent in writing of BANK. The BANK shall have absolute power to refuse such consent or revoke such consent (if given) at any time. The Supplier shall not be relieved from his obligation, duty or responsibility under this Contract even if consent to let or sublet is given by the BANK.
8. NOTWITHSTANDING the provisions contained in clause 4, the BANK shall have the right to cancel the contract for any default on the part of Supplier in due performance thereof.
9. It shall be lawful for the Bank from and out of any money for the time being payable or due to the Supplier from under this contract or otherwise to set off any loss or expense, cost or damages, sustained or incurred by reason of the cancellation of the contract.
10. The Supplier agrees that any communication addressed to him may be handed over to him or his agent personally or left at his residence or place of business or may be sent by pre-paid post to his address as mentioned in this deed.
11. The security deposit shall subject to the conditions specified herein be returned to the Supplier within three months after the expiration of the contract. In all cases where there are guarantee for the goods supplied the security deposit will be released only after the expiry of the guarantee period.
12. In case the supply of articles involves erection of machinery the Supplier agrees that the machinery will be erected within the time and at the place specified by in that behalf. It shall also be the duty and responsibility of the Supplier to see that the machinery thus, erected is

in good working condition to the satisfaction of the person duly authorized by in that behalf and to ensure the proper functioning of the machinery till the guarantee period is over. In the event of the failure of the supplier to erect the machinery within the time and at the place specified by or in the event of the machinery failing to function properly during the guarantee period, the amount spent by and the loss sustained by the Bank on this account by making alternative arrangements shall be recoverable from the supplier in the manner provided in clause 14 hereunder.

13. The Supplier agrees that all sums found due to under or by virtue of these presents shall be recoverable from him and his properties, movable and immovable, under the provisions of the Revenue Recovery Act, for the time being the force as though they are arrears of land revenue or in any other manner and within such time as may deem fit. In deciding what sum of money is due under by virtue of this deed, the Supplier agrees that the decision of the Bank shall be final and conclusive and shall be binding on the Supplier.

Termination of contract if issue remains unresolved after 30 days from date of issue reporting by invoking Performance Bank Guarantee. There would be penalties for breach of service levels as mentioned below, once the installation is completed The penalty amount shall be deducted from the pending payments/ security deposit/ other payments payable or would have to be remitted before the end of the contract.

Note: All penalties shall be made by forfeiting the Performance Bank Guarantee submitted by the supplier or any eligible payments to the supplier. Only Government working days shall be taken into account for the computation of penalty.

The time for ensuring service levels shall be calculated from the time of reporting of the calls at the designated service center.

A service center shall be designated for reporting the problems. It should be accessible over telephone through a toll- free number and online complained registration system. It should be possible to report and obtain status of reported calls in Malayalam.

Any legal disputes between the parties, the same shall be referred to the Court having jurisdiction in

IN WITNESS WHERE OF the Supplier and Shri (Name and designation) for and on behalf of have hereunto set their hands

Signed, sealed and delivered by ..... (Supplier)  
Signature with Seal

In the Presence of witness

- 1.
- 2.

Signed, sealed and delivered by In the Presence of witness 1. 2.

## Annexure -4

### BID FORM

(To be submitted in Letter Head

To

CEO,

The Peoples' Urban Co-operative Bank Ltd

PB No 1. H.O, Main Road, East Fort Gate,Opp Mini Civil Station,

Tripunithura,Ernakulam,Kerala, India - 682301

Sub: Bid Form

Ref. Tender No. xxxxxxxxxxxxxxxxxxxx

Dear Sir,

1. Having examined the conditions of tender contract, the receipt of which is hereby duly acknowledged, I / we, undersigned, offer to supply all hardware & software and execute all works in conformity with tender specifications referred above and also to the said terms conditions of contract for the sum shown in the commercial bid(s) attached herewith and made part of this bid.
2. I / We undertake, if our Bid is accepted, to complete delivery of all items specified in the contract within 45 days calculated from the date of issue of your purchase order/LOI.
3. I / We agree to abide by this Bid up to 180 days and it shall remain binding upon us and may be accepted at any time before the expiration of that period.
4. I/ We understand that you are not bound to accept the lowest or any bid, you may receive.
5. I / We affirm that I / We have enclosed the acceptance of all terms and conditions and also all brochures detailing the technical specification of the items quoted by me/us.
6. The tender document for the works mentioned above have been obtained by me and I / we hereby certify that I / we have read the entire terms and conditions of the tender document, which shall form part of the contract agreement and I / we shall abide by the conditions / clauses contained therein.
7. My/our GST & PAN Numbers are as follows.
8. GST Registration Number. ....
9. PAN Number. ....

Dated this .....day of..... 2025

Signature of In capacity of

Duly authorized to sign the bid for and on behalf of

Witness 1. -----

10. Signature Witness 2. ----- Signature

## **Annexure -5**

### **Format for Manufacturer Authorization Form**

Ref.No. \_\_\_\_\_

To,

CEO,

The Peoples' Urban Co-operative Bank Ltd

PB No 1. H.O, Main Road, East Fort Gate,Opp Mini Civil Station,

Tripunithura,Ernakulam,Kerala, India - 682301

Date:

Sub: RFP ref no: Dear Sir,

Please refer to your Notice Inviting Tenders for New Data Center at the Head Office Building of The Peoples' Urban Co-operative Bank Ltd, Trippunithura

M/S(Bidder), who is our reliable distributor for the last years, is hereby authorized to quote on our behalf for this prestigious tender. We undertake the following regarding the supply of all the equipment's and related software as described in this tender.

1. It will be ensured that in the event of being awarded the contract the machines will be delivered by M/s (Bidder) & maintained by M/S \_\_\_\_\_ properly as per the conditions of the contract. For this purpose, we shall provide M/S (Bidder) necessary technical support including technical updates, software version updates (such as Firmware, Operating System) and upgrades, required patches, replacements & spares to the Bidder as per the RFP conditions. A signed copy of the original equipment warranty agreement (support, repair, replacement) will be submitted to the client / purchaser at the time of installation.
2. If M/s \_\_\_\_\_ (Bidder) fails to maintain the hardware/software and State is compelled to appoint an operator due to non-maintenance of the equipment supplied by us or for any other reason whatsoever, we will provide necessary support to the new operator as appointed by BANK for the remaining period of the project as per the RFP and SLA signed.

3. The equipment supplied will not be under end of life/ end of sale within the duration of project. Also, the equipment supplied in this project will not be declared end of support within five years of its installation (i.e. from the day of Final Acceptance Test approval by BANK). In case it happens M/s \_\_\_\_\_ will have to replace that equipment with equivalent new equipment.
4. If due to any reason whatsoever, the tie up between our Company & M/S (Bidder) breaks down subsequently or supply/installation does not take place for a reason not attributable to State, alternative arrangements as prescribed in earlier points will apply.

Yours faithfully,

(NAME)

(Name of manufacturers)

Note: This letter of authority shall be on the letterhead of the manufacturer and shall be signed by a person competent and having the power of attorney to bind the manufacturer. It shall be included by the Bidder in Pre-Qualification Criteria.

## Annexure -6

### Format for Response to Tender: Technical bid

To,  
CEO,  
The Peoples' Urban Co-operative Bank Ltd  
PB No 1. H.O, Main Road, East Fort Gate, Opp Mini Civil Station,  
Trippunithura, Ernakulam, Kerala, India - 682301

Date

Sir,

Subject: Construction of New Data Center at the Head Office Building of The Peoples' Urban Co-operative Bank Ltd, Trippunithura

Reference: Tender No: <Tender Reference Number> Dated <dd/mm/yyyy>

We, the undersigned Bidders, having read and examined in detail all the Tender documents do hereby propose to build a new Data Center at, The Peoples' Urban Co-operative Bank Ltd, Head Office, Trippunithura.

Supply, Installation, Testing and Commissioning of a new Data Center at, The Peoples' Urban Co-operative Bank Ltd, Head Office, Trippunithura as specified in the Tender document number \_\_\_\_\_ Dated \_\_\_\_\_ along with the following:

#### 1. Earnest Money Deposit (EMD)

We have paid an EMD of Rs. 50000/- (Rupees only). This EMD is liable to be forfeited in accordance with the provisions specified in the tender as per section 2 (Remittance of Tender Document Fee and EMD)

#### 2. Deviations

We declare that Supply, Installation and configuration of all the Equipment included in tender shall be performed strictly in accordance with the Tender documents except for the variations, assumptions and deviations, all of which have been detailed out exhaustively in the "Statement of Deviations from Tender Terms and Conditions", irrespective of whatever has been stated to the contrary anywhere else in our Tender. Further we agree that additional conditions or assumptions, if any, found in the Tender documents other than those stated in deviation schedule shall not be given effect to.

#### 3. Contract Performance Guarantee Bond

We hereby declare that in case the contract is awarded to us, we shall submit the Contract Performance Guarantee Bond in the form prescribed in the Tender.

4. Bid Validity Period agree to abide by this Bid for a period of 180 days after the date fixed for Bid opening or for any further period for which Bid validity has been extended and it shall remain binding upon us and Bid may be accepted at any time before the expiration of that period. We hereby declare that our Bid is made in good faith, without collusion or fraud and the information contained in the Bid is true and correct to the best of our knowledge and belief.

We understand that our Bid is binding on us and that you are not bound to accept a Bid you receive. Thanking you,

Yours faithfully,

(Signature of the Bidder)



## Annexure -7

### Unpriced Detailed Bill of Materials/Technical Specifications /Compliance (Also available in Excel format)

Sno	Description	UOM	Approximate Qty	Quoted product with Make and Mode	Technical compliance (Yes/No)	Deviations (if any)	Remarks (If any)
<b>1</b>	<b>CIVIL &amp; INTERIOR - BILL OF MATERIALS</b>						
<b>1</b>	<b>DISMANTLING WORK</b>						
	Cost for temporary isolation with plastic sheet, necessary frames, openable area for man movement etc. in the area where any dust generating activity to be considered. No additional payment shall be made.						
1.1	Dismantling, removing, Loading and carting away and disposing of the debris as per following demolition work including, soil, rock, broken bricks, blocks and all other non-usable debris and waste materials at an approved location as approved by the regulatory authority and in consultation with the Engineer In Charge (EIC). General housekeeping and surrounding area shall be kept neat and clean on a regular basis.						
a	Dismantling and removing Existing Workstations in the proposed Area	Ls	1.0				
b	Cleaning and Leveling of Existing Flooring in the Proposed Area	Sq. M	55.0				
c	Dismantling, Removing, Cleaning of Terrace Parapet Wall/Half Wall including Glazed windows for making opening for PAC ODU Air flow	Sq. M	30.0				
d	Terrace Vitrified Tile Removal for PAC Foundation	Sq. M	5.0				
<b>2</b>	<b>PARTITION WORKS</b>						
2.1	<b>GYPSUM PARTITION</b> (Note: Control joints to be incorporated wherever the length of the partitions is more than 10m. All GI steel to be as per OEM Recommendation. The rate to be						

Sno	Description	UOM	Approximate Qty	Quoted product with Make and Mode	Technical compliance (Yes/No)	Deviations (if any)	Remarks (If any)
	inclusive of additional frame work for white boards, panelboards, overhead storages, counter fixing.)						
a	<p>Providing and fixing 130-132mm thick double gypsum partition (2hrs fire rated) which includes two layers of tapered edge 15mm thick gyp board (conforming to IS 2095-1982 &amp; 2542-1981) screw fixed with 25mm dry wall screw for first layer and 35mm for second layer at 300mm centers to either side of 48mm studs (0.55mm thick having one flange of 34 mm and another flange of 36 mm made of GI) placed at 610mm center to center in 50mm floor and ceiling channel (0.55mm thick having equal flanges of 32mm made of GI) with joints staggered on each layer to avoid through joints. Finally square and tapered edges of the boards are to be jointed and finished so as to have a flush look which includes filling and finishing with jointing compound, joint paper tape and two coats of drywall topcoat suitable for gyp board (as per recommended practice of OEM). rate shall be inclusive gypsum edge guard on both side of partition with staggered joints.</p> <p>Rate shall be inclusive of 48mm horizontal studs at 2400mm, 1200mm and floor level with salwood reinforcement, channel section to form the glazing/ door opening to be reinforced with sal wood. ply backing to be provided at all switch sockets, network points locations and for skirting as indicated at site.</p> <p>Cost also to include necessary 12mm ply band support for all type of conduit and metal back boxes of switchboard, data, etc complete as per detail drawing. the outer gypsum skin shall be stopped</p>	Sq. M	67.0				

Sno	Description	UOM	Approximate Qty	Quoted product with Make and Mode	Technical compliance (Yes/No)	Deviations (if any)	Remarks (If any)
	75mm above false ceiling in that area, the partition shall be single skin gypsum partition above false ceiling up to bottom of slab. partition only up to false ceiling bottom shall be measured and paid for under this item. however cost to be inclusive of framework and single skin gypsum right up to bottom of rcc slab. necessary cut-outs shall be provided for taking of supply and return air ducts/openings which shall be neatly finished after fixing of ducts thereby leaving no gaps. note all aluminum sections to be standard OEM recommended sections and should have a hologram of the same. the partition should be kept ready to take on paint/wall paper. Cost also to include of making necessary grooves as per design.  Necessary cut-outs shall be provided for taking of supply and return air ducts / openings which shall be neatly finished after fixing of ducts thereby leaving no gaps. mode of measurement to be up to fc level						
b	Providing and filling 50mm thick glass wool insulation of density 24 kg per cum, of approved make wrapped in rp tissues, as per manufacturer's specifications & etc complete as directed by engineer in charge. (inside above gypsum partition)	Sq. M	67.0				
c	Providing and Fixing Cement-Based-Fire- Resistant Board (Bison/Sherra or equivalent Approved make), Double layered seperated with necessary fire resistant frames as per required thickness on the existing windows/openings with proper framing all round to close the windows/openings permanently wherever required and detected. All the Gaps between the Boards, & Wall/Window cutouts shall be	Sq. M	17				

Sno	Description	UOM	Approximate Qty	Quoted product with Make and Mode	Technical compliance (Yes/No)	Deviations (if any)	Remarks (If any)
	properly sealed and finished with POP, Cement or sealant as per requirements.						
<b>2.2</b>	<b>MASONRY WORK</b>						
a	Providing and constructing steam cured aerated cement light weight concrete block masonry work at all levels in cement mortar 1:4 using standard size and of thickness as given below, including all scaffolding, staging, curing, raking of joints for all lifts etc. complete and as directed. rate shall include providing r.c. binder in mix proportion 1:2:4, 75mm thick reinforced with 2 nos. of 8 mm dia fe 415 bars with 8 mm dia tor steel tie bars at 300 mm c/c, rcc binders to be at every 1 meter interval from floor level, including cost of reinforcement and formwork, scaffolding, all labour, hire and fuel charges for all tools and plants employed, proper cover blocks for reinforcement and all other incidental charges etc., all complete as directed by engineer/ pmc. <b>The rate shall be inclusive with 15 mm thick plaster (1:4) on both side.</b>						
	150mm Thick Aerated Block Works (2 Hr Fire Rated)	Sq. M	2				
b	230-280 mm thick brick wall including Plastering, for window closure and glass partition area.	Sq. M	2				
c	Providing and applying in up to 15mm thick plaster on External surface of RCC /Block/Brick/Wall/Floor with cement mortar 1:4,	Sq. M	2				
<b>3</b>	<b>FLOORING WORKS</b>						
	<b>Note:</b> Protection of Tiling to be considered in all the new floor area passage with plastic Cover sheet & POP filling over it.						

Sno	Description	UOM	Approximate Qty	Quoted product with Make and Mode	Technical compliance (Yes/No)	Deviations (if any)	Remarks (If any)
	Providing and fixing following listed floorings in pattern. flooring to be bedded in 20 mm thick cement mortar mix ratio 1:4 (1 cement : 4 sand) including preparing surfaces, spreading cement slurry using cement 2kg/ sqm over prepared surface & 4.5 kg/ sqm over bedding. joints to be cleaned and grouted with matching colour cement grout or approved colour readymade grout with curing, machine polishing, cleaning etc. complete at all leads, lifts and heights as per specifications etc complete as directed by engineer / pmc.						
3.1	Providing and laying cement Plastering to existing flooring where existing tiles are removed. Cement plastering shall be provided to level the area after through cleaning and, chipping and grinding as per the requirement.	Sq. M	20.0				
3.2	Providing and laying 2mm thick vinyl flooring of aproved make, Installation as per manufacturer's catalog method. Joints shall be welded for seamless finish with same material.	Sq. M	15.0				
3.3	Vitrified Tile flooring	Sq. M	15.0				
4	<b>FALSE FLOORING WORKS</b>						
4.1	Supply and Installation of Antistatic Raised floor System, Solid Fill, 600x600 mm, having UDL 1650 kgs/sqmtr, concentrated load of minimum 363 kgs with top performance finish of HPL with Edge Support Rigid Grid (ESRG) understructure system Each floor panel is mechanically secured to the pedestal head at all four corners ensuring maximum rigidity and lateral stability. Stringers are mechanically fastened to the pedestals and the panels are placed on the grid at suitable finish floor height up to 450mm. The system having box stringer design and corner edge support for improving	Sq. M	32.0				

Sno	Description	UOM	Approximate Qty	Quoted product with Make and Mode	Technical compliance (Yes/No)	Deviations (if any)	Remarks (If any)
	lateral rigidity of the grid. It should have antistatic coating.						
4.2	Supply of 19mm nitrile rubber insulation protects the floor from condensation and conduction of heat. The thermal insulation with range of -40Deg C to +115 Deg C having flexibility, mechanical strength of XPE foam. It should have advantages of class O fire properties as per BS476 part 6.	Sq. M	40.0				
4.3	Supply Air Tiles with VCD - Providing and fixing 600mm x 600mm Perforated type Supply air Tiles matching with proposed Raise floor System with VCD, and open area ratio of 55% as per sample approved. Preferred Make of the Supply Air Tiles shall be equivalent to the Raised floor System.	Nos.	4.0				
4.4	Supply of 2 cup tile puller for lifting the raised floor tiles	Nos	1.0				
5	<b>SKIRTING WORKS</b>						
	Providing and fixing skirting's of below listed material. skirting's fixed by fully buttering cement grout on back of it to correct line, level and plumb. joints are well cleaned and grouted with matching colour approved quality readymade grout and curing, cleaning, polishing and including finishing junction of plaster etc complete as directed by engineer / pmc. all complete at all leads, lifts and heights to the satisfaction of eic.						
5.1	100mm ht. Aluminium profile skirting	R. Mt.	50.0				
6	<b>STEP</b>						
6.1	<b>STEP - Server Room Exit:</b> Providing and fixing Step fabricated using MS profile and plate (2mm) finished with two coats of anti-corrosive paint including primer. (Approx. Width - 1200mm, Depth - 900mm, height 0-450mm). Step Shall be covered With 2 mm thick Vinyle and shall be provided with anti skid tape.	kg	125.0				

Sno	Description	UOM	Approximate Qty	Quoted product with Make and Mode	Technical compliance (Yes/No)	Deviations (if any)	Remarks (If any)
6.2	<b>STEP - DC Power Room:</b> Providing and fixing Step fabricated using MS profile and plate (2mm) finished with two coats of anti-corrosive paint including primer. (Approx. Width - 1200mm, Depth - 900mm, height 0-450mm). Step Shall be covered With 2 mm thick Vinyle and shall be provided with anti skid tape.	kg	110.0				
7	<b>RAMP</b>						
7.1	Providing and fixing ramp fabricated using MS profile and plate (3mm) finished with two coats of anti-corrosive paint including primer. (Approx. length - 2500-3000mm, width - 1650mm, height 0-450mm). Loading capacity should be 1800kg/ sq m. Height of handrail - 1200mm. Platform for installing fire suppression cylinders to be provided as per drawing. (3000mmx400mmx450mm). Ramp Shall be covered With 2 mm thick Vinyle and shall be provided with anti skid tape across th ramp at every 300mm interval,	kg	500.0				
8	<b>GRILL WORK</b>						
8.1	Providing and fixing MS Grill fabricated using MS profile, GI Mesh of desired thickness finished with two coats of anti-corrosive paint including primer. As directed by the consultant. Vendor shall submit the GA drawing for approval. Approximate Dimension: Width 10 m x Height 2 m.	kg	200.0				
9	<b>FALSE CEILING</b>						

Sno	Description	UOM	Approximate Qty	Quoted product with Make and Mode	Technical compliance (Yes/No)	Deviations (if any)	Remarks (If any)
9.1	<p>Providing and fixing in the true horizontal level false ceiling system of Armstrong world industries. The suspension system shall be the Armstrong Trulock Silhouette revealed profile grid system with 15mm wide flanges incorporating a 3mm or 6mm central recess color black or white revealed Silhouette main runners and cross tees to have mitered ends with birds mouth notches to provide mitered cruciform junctions. Main runners to be spaced at 12mm c/c fixed by using 2mm pre straightened GI Wire. Main tee, rotary stitched of size 15mm x44mmx3600mm at every 1200mm c/c maximum and 1200mm cross tee of size 15mmx44mm x1200mm at every 600 mm c/c maximum and 600mm c/c cross tee of size 15mmx44mmx600mm at every 1200mm c/c maximum and 19mmx19mmx3000 wall angle allround the wall to form grid size of 600mmx600mm and suspending the grid using 2mm pre straightened GI Wire and 6mm nylon raw plug at every 1200mm intervals at the main tee and laying of dunne premier micro look mineral fiber tiles manufactured by Armstrong world industries of size 600mmx600mmx15mm over the formed grid complete as directed.</p>	Sq. M	13.0				
9.2	<p>Providing, supplying, and fixing in position of Gypsum Board False Celing as per manufacturers specification and instructions with 12.5 mm thk board.Gypboard Screw- fixed to the underside of suspended G.I grid. G.I grid should be constructed and suspended from the main ceiling as per the manfacutures instructions and as per the specifications using original Co. Specified framework sections G.I24 Guage the Gypboard should be fixed to G.I Grid with 25mm long Drawali Screws.the Gypboard to be</p>	Sq M	5.0				



Sno	Description	UOM	Approximate Qty	Quoted product with Make and Mode	Technical compliance (Yes/No)	Deviations (if any)	Remarks (If any)
	used should be 12.5mm thk tapered edge boards. the boards should be taped and filled from underside to give smooth, seamless ceiling.						
9.3	SITC of 13mm thick Aluminium foiled Armaflex Nitrile rubber insulation.	Sq. M	50.0				
<b>10</b>	<b>DOORS</b>						
10.1	Providing & fixing fire rated metal door with vision panel of size – 300mm x 300. with 2 hrs fire rating and shall have mortice dead lock with one side key and thumb turn. frame shall be made up of 1.6 mm thick galvanized steel with a double rebate (8 bend) profile of 145 x 60 mm with atleast 4 nos. holdfasts / anchor fasteners provided on each side for grouting and implementation for all fire doors fire rating certificate should be provided. Door shall be provided with handle outside and 100 x 300 mm ss plate at internal side, door closures, tower bolts and all required accessories all complete, of approved make.						
a	Single Leaf 2 HRS Fire Rated Metal Door of size 1200 x 2200mm	Nos	1				
b	Single Leaf 2 HRS Fire Rated Metal Door of size 900 x 2200mm	Nos	2				
c	Single Leaf 2 HRS Fire Rated Metal Door of Size 900 X 2200 mm emergency door with panic bar	Nos	1				
10.2	Partially Glazed Aluminium Single leaf Door Of Size 1000x2200 with all accessories including Hinges, Automatic Door Closure, Handle, Tower bolts, Door lock & Key etc all complete.	Nos	Rate Only				
10.3	Providing & Fixing M.S."C" Channel/MS Box Pipe for fire door fixing including two coat red oxide primer and paint, anchor fasteners shall be included.	Kg	330				
<b>11</b>	<b>PAINTING WORKS</b>						

Sno	Description	UOM	Approximate Qty	Quoted product with Make and Mode	Technical compliance (Yes/No)	Deviations (if any)	Remarks (If any)
	Providing and applying three or more coats (as specified below) of approved brand, manufacturer and shade to give a smooth finish on plastered surfaces or gypsum partitions & ceilings over a coat of approved primer including the cost of preparing the surfaces with filling materials (putty), along with sand papering wherever required, including thoroughly brushing the surface free from foreign matter, sandpapering smooth, filling in all holes and cracks etc. Complete., rate to include all tools, labour, scaffolding, primer as required, complete as directed by the Engineer/ PMC.						
11.1	Providing and applying three coats of fire retardant paint of approved make to all internal walls of approved colour over a coat of water based primer including preparation of surface by thorough cleaning and wetting and applying readymade putty of approved make etc. complete as directed by Engineer / PMC.	Sq. M	115.0				
11.2	Providing and applying three coats of plastic emulsion paint of approved make to all internal wall, ceilings, of approved colour over a coat of water based primer including preparation of surface by thorough cleaning and wetting and applying readymade putty etc. complete as directed by Engineer / PMC.	Sq. M	120.0				
11.3	Providing and applying three coats of Epoxy paint of approved make to Floor, Surface of approved colour over a coat of OEM approved primer including preparation of surface by thorough cleaning and leveling etc. complete as directed by Engineer / PMC.	Sq. M	29.0				
<b>12</b>	<b>CUTOUT &amp; FIRE SEALANT</b>						
12.1	Making of cutout in brick partition, Gypsum cutting or any of the opening which is necessary to	Sq. M	1.0				

Sno	Description	UOM	Approximate Qty	Quoted product with Make and Mode	Technical compliance (Yes/No)	Deviations (if any)	Remarks (If any)
	passing the cable & cable tray where and there. The rate shall be inclusive of making the cutout and refinish the surface smooth & all necessary structure supports like scaffolding etc.						
12.2	<b>Fire Stop foam:</b> Rigid and fast-curing firestop foam with excellent water resistance to help create a fire, smoke and moisture barrier around cable and mixed penetrations. Thickness of wall/floor cutout - 200mm. Preferred Make: Hilti or 3M	Sq. M	1.0				
<b>13</b>	<b>PARTLY GLAZED ALUMINIUM BOXING</b>						
13.1	Providing and fixing full height partly aluminium fixed-louvered, partly glazed partition with following specifications. Providing and fixing partly glazed partitions made out of Frame work to be 50mm X 50mm X 1.60 mm thick aluminum section weight not less than 0.836 kg/rmt with maximum distance of 450mm c/c bothways (Horizontal/Vertical) or as directed, firmly fixed to floor or slab with 65 to 75 mm long screw or as directed by Engineer in charge as per site conditions with necessary grooves and cuts etc. upto the height of false ceiling (approx. 2350mm ht.). Anti-rodent mesh to be provided inside the louver. Front side shall be completely openable using sliding doors. The partition will be provided with 6 mm thick toughened glass fixed on top half. Bottom half shall be louver. Members should be fixed to roof slab and platform.	Sq. M	11.0				
<b>14</b>	<b>HOUSE KEEPING</b>						
14.1	House keeping - Providing house keeping and keep the site clean till the handover with proper supervision	Lot	1.0				

Sno	Description	UOM	Approximate Qty	Quoted product with Make and Mode	Technical compliance (Yes/ No)	Deviations (if any)	Remarks (If any)
15	LOGO & SIGNAGES						
15.1	photo luminescent type Logo & signages with hanging/ sticking accessories as per requirement.	Sq. M	2.0				
2	BILL OF MATERIALS - ELECTRICAL LOWSIDE						
1.0	EARTHING SYSTEM - ELECTRODES AND CONDUCTORS						
1.1	Earthing Bars						
	Supply and installation of following bus bars on insulators with suitable holes for connecting earthing conductors of upto 1Cx120 sq mm Cu cable as per specification. This bus bar shall be mounted either on floor or wall as directed by consultant.						
1.1.1	300x150x6mm Cu. Busbar on insulated Supports and necessary Holes to connect earthing conductor	Nos.	2				
1.1.2	300x150x6mm Gl. Busbar on insulated Supports and necessary Holes to connect earthing conductor	Nos.	1				
1.2	Earthing PITS						
	<b>Cu Plate Earth Pit</b> Supply of materials and providing 600 X 600 X 3mm Cu Plate earth station. As per IS:3043/87 including excavation of earth in all classes of soil, with G.I. pipe with funnel, salt, charcoal etc all complete Including civil work, manhole chambers and cover.	Nos	2				
1.3	<b>Supply and installation of earthing Strips (All terminations and joints shall be tinned or coated with anti-corrosive materials which does not affect the conductivity). When laid underground, it shall be at a depth of 500mm. Conductors above soil has to be supported with necessary insulators and clamps.</b>						
1.3.1	25x6 mm Gl. Strip	Rmt	220				
1.3.2	25x3 mm Cu. Strip	Rmt	33				

Sno	Description	UOM	Approximate Qty	Quoted product with Make and Mode	Technical compliance (Yes/No)	Deviations (if any)	Remarks (If any)
1.3.3	4mm braided Cu. Wire with clamps and lugs	Rmt	15				
1.3.4	Earthing links	Nos.	2				
1.3.5	FRP insulators, suitable for 433V, with necessary fasteners to support earth strips.	Nos.	80				
<b>1.4</b>	<b>Earthing Cables</b>						
1.4.1	1Cx95 Sqmm Cu. CONDUCTOR PVC FLEXIBLE CABLE (Green Colour)	Rmt	67				
	End termination	Nos.	8				
1.4.2	1Cx70 Sqmm Cu. CONDUCTOR PVC FLEXIBLE CABLE (Green Colour)	Rmt	25				
	End termination	Nos.	6				
1.4.3	1Cx16 Sqmm Cu. CONDUCTOR PVC FLEXIBLE CABLE (Green Colour)	Rmt	39				
	End termination	Nos.	34				
1.4.4	1Cx10 Sqmm Cu. CONDUCTOR PVC FLEXIBLE CABLE (Green Colour)	Rmt	113				
	End termination	Nos.	18				
1.4.5	1Cx6 Sqmm Cu. CONDUCTOR PVC FLEXIBLE CABLE (Green Colour)	Rmt	36				
	End termination	Nos.	26				
1.4.6	1Cx4 Sqmm Cu. CONDUCTOR PVC FLEXIBLE CABLE (Green Colour)	Rmt	20				
	End termination	Nos.	4				
<b>2.0</b>	<b>Cable Trays</b>						
	Supply & Installation of Following Cable Trays and Raceways with all accessories and supports that includes but not limited to Steel items-GI, for supporting cable trays, like angle iron, bolts, nuts, anchor bolts etc all complete.						
<b>2.1</b>	<b>Ladder type cable tray</b>						
2.1.2	GI Tray Size :300 mm x 50 mm	Rmt	13				
2.1.3	GI Tray Size :150 mm x 50 mm	Rmt	62				
<b>2.2</b>	<b>Perforated type cable tray</b>						
2.2.1	GI Tray Size :300 mm x 50 mm with cover	Rmt	5				
2.2.2	GI Tray Size :150 mm x 50 mm with cover	Rmt	12				
2.2.3	GI Tray Size :50 mm x 50 mm with cover	Rmt	38				
<b>2.3</b>	<b>MS Raceways with cover</b>						

Sno	Description	UOM	Approximate Qty	Quoted product with Make and Mode	Technical compliance (Yes/No)	Deviations (if any)	Remarks (If any)
	Raceways shall be powder coated with a preferred colour approved by consultant. Race way shall be provided with required number of cutouts to mount 16A/32A 3Pin IEC 309 Sockets on the Raceway.						
2.3.1	Raceway :300 mm(W) x 150(H) mm with perforated cover	Rmt	12				
2.4	<b>Mesh type cable tray</b>						
2.4.1	450x50mm Cable tray	Rmt	25				
2.4.2	300x50mm Cable tray	Rmt	5				
2.4.3	Steel items-GI, for supporting NW cable trays, like angle iron, hi-tech rods, bolts, nuts, anchor bolts etc.,	Kgs.	100				
3.0	<b>LIGHTING SYSTEM</b>						
3.1	<b>LIGHT FIXTURES</b>						
3.1.1	2FTx2FT SIZE, 40 W LED SURFACE MOUNTED/SUSPENDED LUMINAIRE making earthing connection complete to be recessed in false ceiling with all necessary hardwares	Nos.	6				
3.1.2	2FTx2FT SIZE, 40 W LED RECESS MOUNTED LUMINAIRE making earthing connection complete to be recessed in false ceiling with all necessary hardwares	Nos.	2				
3.1.3	12 W Round LED DOWN LIGHT pressure die cast aluminium fixture to be recessed in false ceiling with all necessary hardwares, chains, hook etc. complete.	Nos.	2				
3.1.4	LED tube light 1 x 20 W ( 2000 lumens )	Nos.	4				
3.2	<b>SUB MAINS / CIRCUIT MAINS</b>						
3.2.1	1100 V grade ,3Rx2.5 sq.mm wires, multi strand copper in 19mm dia conduit.(from DBs, up the switch point).	Rmt	60				
3.2.2	3Rx1.5 sq.mm wires, multi strand copper in 19mm dia conduit.	Rmt	60				
3.2.3	3Cx2.5 sq.mm cable(YY) with PVC-FRLS	Rmt	25				
3.2.4	3Cx4 sq.mm cable(YY) with PVC-FRLS	Rmt	25				
3.2.5	32mm dia FRLS conduit	Rmt	20				

Sno	Description	UOM	Approximate Qty	Quoted product with Make and Mode	Technical compliance (Yes/No)	Deviations (if any)	Remarks (If any)
3.2.6	25mm dia FRLS conduit	Rmt	20				
<b>3.3</b>	<b>POINT WIRING</b>						
3.3.1	1 light point controlled by a 6 A switch	Nos.	4				
3.3.2	2 to 3 lights controlled by a 6 A switch	Nos.	3				
<b>4.0</b>	<b>POWER RECEPTACLES.</b>						
	Supply, implementation of switched socket outlets, modular socket outlets and switches mounted separately for group control on wall and modular type partition with front plate & accessories including civil works like chipping etc. Colour of plates(Glossy plates): Different Colours for UPS power & Raw power						
4.1	3 x 6A multi socket controlled by 16A switch	Nos.	4				
4.2	2 x 6A multi socket controlled by 16A switch	Nos.	2				
4.3	1 x 6/16A twin socket controlled by 16A switch	Nos.	4				
4.4	1 x 6A multi socket controlled by 6A switch	Nos.	4				
4.5	32A 3Pin IEC 309 to be Mounted on overhead Raceway above IT Racks	Nos.	10				
4.6	16A 3Pin IEC 309 Socket with 16A 2P C-curve MCB with Box	Nos.	4				
<b>5.0</b>	<b>CABLES &amp; END TERMINATIONS.</b>						
	1100 V grade, stranded(above 10Sq.mm) copper/aluminium conductor, XLPE insulated , FRLS, PVC Inner sheathed, armoured/unarmoured, PVC Outer sheath cables as per IS1554.. The cables shall be laid in tray/built up trench etc., Rate shall exclude cost of tray/trench.						
	End termination :Providing end Termination of cables with supply of brass, double compression cable glands & solderless crimping type heavy duty aluminium lugs for aluminium cables & bimetal/ copper lugs for copper cables. End termination shall also include						

Sno	Description	UOM	Approximate Qty	Quoted product with Make and Mode	Technical compliance (Yes/No)	Deviations (if any)	Remarks (If any)
	braided earthing.						
	Cable tagging: All cables shall be tagged on both sides with aluminium plate (approx. 20mmx80mm) containing cable details and feeder details. It shall be tied using PVC cable ties.						
5.1	4Cx70 Sqmm AL. Ar. XLPE INSULATED FRLS CABLE	Rmt	92				
	End termination	Nos.	6				
5.2	4Cx16 Sqmm AL. Ar. XLPE INSULATED FRLS CABLE	Rmt	47				
	End termination	Nos.	8				
5.3	4Cx10 Sqmm AL. Ar. XLPE INSULATED FRLS CABLE	Rmt	10				
	End termination	Nos.	2				
5.4	4Cx6 Sqmm AL. Ar. XLPE INSULATED FRLS CABLE	Rmt	20				
	End termination	Nos.	4				
5.7	3Cx6 Sqmm Cu. Un. Ar. PVC FLEXIBLE FRLS CABLE	Rmt	122				
	End termination	Nos.	32				
5.8	3Cx4 Sqmm Cu. Un. Ar. PVC FLEXIBLE FRLS CABLE	Rmt	100				
	End termination	Nos.	12				
5.9	3Cx2.5 Sqmm Cu. Un. Ar. PVC FLEXIBLE FRLS CABLE	Rmt	42				
	End termination	Nos.	16				
5.10	1Cx25 Sqmm Cu. CONDUCTOR PVC FLEXIBLE FRLS CABLE	Rmt	78				
	End termination	Nos.	16				
5.11	1Cx10 Sqmm Cu. CONDUCTOR PVC FLEXIBLE FRLS CABLE	Rmt	135				
	End termination	Nos.	32				
5.12	1Cx6 Sqmm Cu. CONDUCTOR PVC FLEXIBLE FRLS CABLE	Rmt	10				
	End termination	Nos.	4				
5.13	1Cx4 Sqmm Cu. CONDUCTOR PVC FLEXIBLE FRLS CABLE	Rmt	10				
	End termination	Nos.	4				
5.14	1Cx2.5 Sqmm Cu. CONDUCTOR PVC FLEXIBLE FRLS CABLE	Rmt	10				
	End termination	Nos.	4				
<b>6.0</b>	<b>MISCELLANEOUS</b>						
6.1	Shock treatment chart laminated	Nos.	2				
6.2	Supply & Installation of	Nos	2				



Sno	Description	UOM	Approximate Qty	Quoted product with Make and Mode	Technical compliance (Yes/No)	Deviations (if any)	Remarks (If any)
	evacuation Plan with Auto Glow in A3 with 3 mm mounting foam sheet in Frame						
6.3	First aid kit	Nos.	1				
6.4	Rubber mat 1100V grade ISI approved 2 m x 1m.	Nos.	4				
<b>7.0</b>	<b>STATUTORY APPROVALS</b>						
	Professional charges towards Preparation and Submission of asbuilt drawings, (hard and soft copy - 4 sets), Preparation of drawings in necessary formats for the approval of scheme by Local electricity authority.	LS	1				
<b>3</b>	<b>BILL OF MATERIALS - ELECTRICAL PANELS</b>						
	<b>Design, supply implementation, testing and commissioning of Switch Boards, comprising of incomer panels, outgoing panels, bus coupler, Circuit Breaker with electrical as well as Mechanical Interlock and necessary indications, required qty of Current Transformers, Indication Lamps etc as per SLD</b>						
	Design, Fabrication, Supply, Erection, Testing and Commissioning of the following fully Compartmentalized, Dust tight, Vermin proof, LT (440Volts) Switchboards fabricated out of 14 SWG CRCA Sheet chemically treated and Powder coated of approved shade. The switchboards should have a suitable rated TPN Aluminium/Copper Busbars as specified with necessary Ampere rating, Specified Short Circuit Capacity for 1Sec. The busbars should be heat shrinkable PVC sleeved with SMC/DMC Finger type Busbar supports. All the outlets, incomers and Meter cubicles should be labelled using Black PVC computer printed Stickers. Internal Power / Control wiring with FRLS Copper Flexible Wires. The design should						

Sno	Description	UOM	Approximate Qty	Quoted product with Make and Mode	Technical compliance (Yes/No)	Deviations (if any)	Remarks (If any)
	be as per standards of the Kerala State Electrical Inspectorate						
1	<p><b>DC Main Panel A &amp; B</b> Top/Bottom cable entry for incoming and outgoing feeders. Fabricated out of 14SWG CRCA sheet. Rotary FD Kit shall be provided for all MCCBs. A class "B" SPD,10/350μs, 50kA, with built in Disconnecter shall also be provided for each Bus Bar of this panel as per Electrical Schematic Diagram. PLC based interlocking to be provided between the incomer breakers.</p> <p><b>1) Busbars:</b> 160A 4P Cu. Busbar for phase and neutral - 1no. Earth bus.</p> <p><b>2) Incomer 1 &amp; Incomer 2:</b> 125A, 25 kA 4P MCCB with thermal magnetic S/C, O/L protections, LSIG Type with NO/NC contacts for ON/OFF/Trip, 160A 4P contactor, Communication to BMS-All 2sets.</p> <p><b>Meters &amp; Indications:</b> 3phase Digital Combination meter EM6400NG of SCHNEIDER/CONZERV with Volts, Amps, KW, VA,kWH,kVAH,PF, THD etc with 3nos resin cast metering CTs Class1, 15VA, 150/5A, RS485 Modbus Interface - All 2sets. Red, Yellow &amp; Blue LED Indication Lamps 3nos, 2A Control fuses with toggle switch - 2sets. Red/Green/Ambur, On/Off/Trip LED Indication Lamps 3nos, 2A Control fuses with toggle switch - 2sets.</p> <p><b>3) Outgoings:</b> 4P, 63A, 10kA C- curve MCB - 2Nos.</p>	Nos	2				

Sno	Description	UOM	Approximate Qty	Quoted product with Make and Mode	Technical compliance (Yes/No)	Deviations (if any)	Remarks (If any)
	4P, 40A, 10kA C- curve MCB - 4Nos. 4P, 32A, 10kA C- curve MCB - 2Nos.						
2	<b>DC PDU A &amp; B</b> Top /Bottom cable entry for incoming and outgoing feeders. Fabricated out of 16SWG CRCA sheet. Rotary FD Kit shall be provided for all MCCBs.  <b>1) Busbar:</b> 160A P+N+E,Cu. Busbar for phase and neutral - 1no & Insulated Earth bus for Equipment earthing. <b>2) Incomer:</b> 125A 2P, 25kA MCCB-1no with S/C and O/L protection. <b>Indications:</b> Red/Green/Ambur, On/Off/Trip LED Indication Lamps 3nos, 2A Control fuses with toggle switch - 1set. <b>4) Outgoings:</b> 32A DP, D-Curve MCB - 7nos., 16A DP, D-Curve MCB - 2nos.	Nos	2				
3	<b><u>40A 4P Manual Changeover Switch with Enclosure</u></b> Top & Bottom cable entry for incoming and outgoing feeders. Fabricated out of 16SWG CRCA sheet 40A 4P Manual changeover with necessary protections as per Local Electrical Inspectrate standard. <b>Indicators</b> Red, Yellow & Blue LED Indication Lamps 3nos, 2A Control fuses with toggle switch - 2set Red/Green, Source On/Off LED Indication Lamps 2nos, 2A Control fuses with toggle switch - 2set.	Nos	Rate Only				
4	<b>RCBO with Enclosure:</b> Supply and installation of FP RCBO of rating 40A, 100mA with power coated enclosure on wall as per site requirement.	Nos.	2				

Sno	Description	UOM	Approximate Qty	Quoted product with Make and Mode	Technical compliance (Yes/No)	Deviations (if any)	Remarks (If any)
5	<b>MCB BOX- UPS Output</b> 125A, 2P, MCB Isolator in enclosure with all fittings and accessories	Nos	2				
6	<b>MOBILE DG TERMINATION BOX</b> 125A, 4P, MCCB Isolator in Outdoor Type enclosure with all fittings and accessories	Nos	1				
7	Supply and fixing of 125A 4P MCCB 36KA DNO with all accessories in existing MSB's after removing existing 80A switch gear and Accessories. This shall include necessary connection cables/Links/Busbar and all accessories.	Nos	1				
8	<b>Utility DB A &amp; B</b> Supply, Installation, Testing and Commissioning of of factory made 4 way Horizontal TPN MCB DB with IP42 protection, prewired as per technical specification. <b>Incomer:</b> 32 4P MCB with 32A 300mA RCCB. <b>Outgoings:</b> 20A DP MCB - 6nos.	Nos.	2				
9	<b>LDB:</b> Supply and installation of factory made 8 way SPN DB. Incomer: 20A DP MCB, 30mA RCCB Outgoings: 6/10A SP MCB - 6nos.	Nos.	1				
10	<b>PDB:</b> Supply and installation of factory made 8 way SPN DB. Incomer: 20A DP MCB, 30mA RCCB Outgoings: 6/10A SP MCB - 6nos.	Nos.	1				
11	<b>MCB DB- UPS</b> <b>Incomer:</b> 32A, DP MCB <b>Outgoing:</b> SP, 6/10A MCBs - 8 Nos.	Nos	1				
<b>4</b>	<b>BILL OF MATERIALS - UPS SYSTEMS</b>						
1	Supply, installation, and commissioning of online double conversion technology <b>16kVA/16KW UPS (Scalable Upto 20kVA/20KW)</b> Rack mountable UPS with Gravity sense LCD Display Parallalable/ Scalable upto 4 Units; Three phase input and configurable output for single phase/ Three phase as per requirement.	Set	1				

Sno	Description	UOM	Approximate Qty	Quoted product with Make and Mode	Technical compliance (Yes/No)	Deviations (if any)	Remarks (If any)
	<p>UPS shall be indoor type with inbuilt surge protection, Input p.f - 0.99(full load), input THDi &lt;5% without using any external filters, wide input voltage range 176-288VAC (full load),100-176VAC(linear derating),100VAC(Half Load) Frequency 50-60Hz. Integrated Ethernet &amp; Modbus Port with HTTP Protocol compatibility &amp; streamlined remote monitoring, Option for adding additional intelligent cards (SNMP &amp; Modbus protocol) which can be integrated with BMS &amp; Remote monitoring devices. UPS shall be 100% generator compatible, with efficiency upto 96.2% and should reach upto 99% in ECO mode. The UPS shall deliver power at output power factor of 1. The UPS shall comply to EN 62040-1, IEC 62040-2,IEC 62040-3,VFI -SS-111 and relevant IS &amp; other statutory Norms.The acoustic noise at 1 metre of the system should be 58dB. The system shall be true online double conversion DSP based UPS system and UPS shall be with built-in automatic bypass facility.</p> <p>UPS should have adjustable battery configuration from 24 to 40 no's of Batteries as per capacity scalability requirement. 24 to 40 Batteries for 16kVA/16kW Capacity and 32-40 Battery configuration for 20kVA/20kW Capacity.</p>						
2	<p>24nos of 84Ah sealed maintenance free (SMF) VRLA batteries for 60 minutes backup @16kVA/16kW full load capacity with suitable size battery rack(s), battery isolators interconnection cables between UPS and batteries etc. including all accessories as required</p> <p>24 No's X 42 Ah X 2 set (Total</p>	Set	1				

Sno	Description	UOM	Approximate Qty	Quoted product with Make and Mode	Technical compliance (Yes/No)	Deviations (if any)	Remarks (If any)
	84AH), 12V SMF VRLA battery, for 60mins backup. 12V sealed maintenance free VRLA batteries (SMF VRLA) with required number of batteries to attain minimum 24192 VAh for providing Desired Back up for each UPS.						
3	Supply and installation of Battery accessories like battery rack(s), Interconnecting cables, battery isolators etc. for 42Ah x 48 nos Batteries	Set	1				
4	Disconnection & Reinstallation of Existing 6 kVA UPS System with Batteries and accessories like battery rack(s), Interconnecting cables, battery isolators etc.	Set	1				
5	<b>BILL OF MATERIALS - PAC SYSTEMS</b>						
1	<b>PAC - Precision Air Conditioning system</b>						
	<p>Supply, Unloading, Lifting, Shifting and Positioning at site of Bottom Throw PAC unit having Rated Capacity of 21 kW (5.9 TR), with Digital Scroll Compressor. Floor Mounted Type, Bottom Discharge , Single circuit Air-Cooled DX type Precision Air conditioners of minimum 19 kW Gross cooling capacity with SHR Ratio 1.00 at return air temperature of 24 deg C DB &amp; 50% RH and Outdoor Ambient Condition @37 Deg C with R410 A Refrigerant Gas).</p> <p>Indoor unit : The Indoor unit shall comprise of Variable capacity Digital Scroll compressor, Variable Evaporator Fan complete with Backward curved type with EC motor, Evaporator DX Cooling Coil , Microprocessor controllers, Thermal Expansion valves, Driers, G4 Filter, Suction and Discharge piping, Internal power and Control wiring, Crankcase heaters, HP/LP Cut outs, Power and Control contacts and Other Electrical</p>	Lot	2				0.00

Sno	Description	UOM	Approximate Qty	Quoted product with Make and Mode	Technical compliance (Yes/No)	Deviations (if any)	Remarks (If any)
	<p>accessories. Outdoor Condenser unit : The Outdoor Condenser unit shall comprise of Condenser fans &amp; motor, Condenser cooling coil (Copper coil with aluminium fins) and Isolator switch.</p> <p>PAC Unit shall be provided with in-built Intelligent Communication ICOM Display, that should feature a unique control algorithm designed to manage the operation of the PAC units, ensuring top reliability in all conditions. The display shall allow access to the unit via the Network, making coordination between PAC units within the same room possible as a result of the integrated Ethernet connection. The self-monitoring of redundant units alternates standby positions and gives priority to possible hot spots. Controller shall be capable of high-level supervision of multiple units that should allow them to work together as a single system optimizing room temperature and humidity. Intelligent Controller shall be capable of manage the reduction of fan speed whenever operation at full capacity is not required, this shall modulate both fans and compressors thus increasing the entire system's efficiency. This controller shall be capable to directly connect with the facility network (Ethernet) and enables communication between multiple PAC units for synchronized operation, guaranteeing increased reliability and precision cooling room control.</p>						
2	<b>PAC - Lowside Work:</b> <b>Lowside Works of Precision AC units comprising of:</b>						
2.01	Lifting ,Shifting and positioning of PACs after unloading at site.	Nos	2				
2.02	Installation and commissioning	Lot	2				
2.03	R410A Gas Charging: Refrigerant	KG	60				

Sno	Description	UOM	Approximate Qty	Quoted product with Make and Mode	Technical compliance (Yes/No)	Deviations (if any)	Remarks (If any)
	Gas, R-410A						
2.04	Indoor stand	Nos	2				
2.05	Outdoor Stand	Nos	2				
2.06	Interconnecting Copper piping between indoor & outdoor unit. Copper piping will be duly insulated (Supply)	mtr	30				
2.07	Interconnecting Copper piping between indoor & outdoor unit. Copper piping will be duly insulated.(return)	mtr	30				
2.08	Sequencing Work of 2 units including necessary communication Cable (at fixed interval)	Lot	1				
2.09	3 C x 2.5 Sq.mm Copper FRLS Cable (from IDU to ODU)	RMT	40				
2.10	Drain Pipe 40mm HDPE with insulation	Rmt	5				
2.11	25 mm Dia CPVC Drain Pipe with Insulation	RMT	10				
2.12	12 mm Dia PVC Drain Pipe without Insulation	RMT	15				
2.13	Humidifier Pipe 25mm HDPE	Rmt	30				
2.14	Ball Valve for Humidifier line	Nos	3				
2.15	Cable Tray with cover	Rmt	15				
2.16	Scaffolding for piping	Lot	1				
2.17	Angular Support for piping	Lot	1				
2.18	Minor Civil work	Lot	1				
<b>6</b>	<b>BILL OF MATERIALS - SPLIT AC SYSTEMS</b>						
<b>1</b>	<b>Split AC - Power Room Air Conditioning System</b>						
1.1	Supply of 1.5 Tr, 5-Star Rated Split AC ,Indoor and Outdoor units with all Accessories.	Nos	4				
1.2	Installation of 1.5 Tr Split AC ,Indoor and Outdoor units with necessary cabling Indoor and Outdoor stand, stabilizers etc	Nos	4				
<b>7</b>	<b>BILL OF MATERIALS - RACK &amp; ACCESSORIES</b>						



Sno	Description	UOM	Approximate Qty	Quoted product with Make and Mode	Technical compliance (Yes/ No)	Deviations (if any)	Remarks (If any)
1	<p><b>42U RACK - W 800mm x D 1200mm:</b>  Ultra Rigid Rack of 42U size with W: 800mm x D: 1200mm for high density application in data centers &amp; server rooms specially designed for seismic zone. The racks manufactured out of steel sheet, punched, formed, welded and Powder coated with highest quality standards under stringent ISO 9001   ISO 14001   ISO 27001   ISO 45001 Manufacturing &amp; Quality management system to ensure highest quality product.</p> <p>Standard for racks configuration will be welded to ultra rigid frame with 4 no pillars of 14 Gauge steel sheet 5 folded profile welded to top and bottom ribbed/ reinforced frame additionally supported depth wise by welding 6 no depth rail 4 folded 75mm 14 Gauge profile &amp; diagonally reinforced by 4 no of 4 folded 50mm 14 gauge profile. Associated with vented top cover with fan mounting provision Front perforated Metal Door with Lock &amp; Key and Back Vented / Perforated Metal Door with Lock &amp; key and Plain side panels 1200 deep rack will be configured with dual side panel. Braced to floor/ raised floor with bracing bolts and additionally braced on top by runway to rigid wall OR Pillar</p>						
	<p><b>FEATURE</b>  Conforms to DIN 41494 or Equivalent EIA / ISO / EN Standard. Designed to NEBS™ Zone 4 via Telecordia GR-63-CORE. Adjustable mounting depth. 4 No. Adjustable, 19" verticals with Punched 9mm Square Hole and Universal 12.7mm – 15.875mm – 15.875mm alternating hole pattern offers greater mounting flexibility, maximizes usable mounting space. Numbered U positions. Universal 25MM Pitch Holes For ETSI</p>						

Sno	Description	UOM	Approximate Qty	Quoted product with Make and Mode	Technical compliance (Yes/No)	Deviations (if any)	Remarks (If any)
	Standard Racks. State-of-the-art manufacturing methods provide the best product quality and fastest delivery in the industry. 100% assured compatibility with all equipments conforming to DIN 41494 (General industrial standard for equipments). Powder coated finish with Seven tank pretreatment process meeting IS. Grounding & Bonding Options. Earthing continuity Kit. 2 or 4 Fan module Mount Provision on top cover. <b>TECHNICAL DATA</b> Basic Frame: Steel Folded Construction: Welded Top & Bottom Cover: Welded to Frame with Cable entry exit cut outs Front Door: Lockable Perforated steel Door Plain /Vented Rear Door: Lockable Perforated steel Door Plain /Vented 19" Mounting Angle: Formed Steel Standard Finish: Powder coated Standard Colour: Black Standard Mounting: Braced to Floor/ Raised Floor Bracing Bolts Rack Standard: Conforms to DIN 41494 or equivalent standard Static Load: 1500 Kg Seismic Load: 750 Kg						
	ACCESSORIES: Cooling Fans, Shelf, 10 Socket Horizontal PDU, Cable Manager 1U loop, Rack Hardware Kit						
	<b>Rack U Size: 42RU</b> <b>Dimension (W x D x H): 800 mm x 1200mm x 2010mm.</b>	Nos	1				
8	<b>BILL OF MATERIALS - FIRE ALARM &amp; SUPPRESSION SYSTEM</b>						
	Fire Detection and Suppression system: Design, Supply, Installation, Testing and Commissioning of FK5112 clean agent based, 42 bar working pressure Fire Suppression System, designed for highest degree of Suppression, protection						

Sno	Description	UOM	Approximate Qty	Quoted product with Make and Mode	Technical compliance (Yes/No)	Deviations (if any)	Remarks (If any)
	& minimum extinguishing time for the enclosed area at uniform extinguishing concentration comprising of following components and related accessories, connection etc. as per specifications						
1	SITC of 67.5 Ltr Seamless CCOE/PESO approved Cylinder with necessary Cylinder strap and manifold complete as required	Nos	1				
2	Supply of FK5112 Clean agent	Kg	58				
3	SITC of Master single cylinder kit Comprising Pressure guage, low pressure supervisory switch, electro magnetic actuator, pneumatic actuator, flexible discharge hose, flexible actuation hose, manual actuator etc.	Nos	1				
4	SITC of Pressure switch	Nos	1				
5	Supply, erection, jointing, testing and commissioning of MS seamless pipe as per ASTM A106, Grade B, Schedule 40 . (Server room)	Lot	1				
6	SITC of Nozzle	Nos	2				
7	SITC of 2 zone Gas Release Panel: The panel shall be a micro controller based agent release panel. The panel shall packed control unit for dual function of detection and controlled release of gas agent. The panel shall have all the safety features to prevent accidental release. The panel shall be wall mounted type, fabricated out of 18 guage CRCA sheet, dust and vermin proof, IP50 degree protection with powder coated finish. The panel shall be in all respect suitable for operation in 220V AC, 50 Hz power supply and battery charger complete with 2 nos of 12V, 7AH maintenance free battery complete as required	Nos	1				
8	SITC of Conventional Multi detector: The detector shall be designed to work with all conventional panels. The detector shall sense both smoke and rate of rise of temperature also. The	Nos	8				

Sno	Description	UOM	Approximate Qty	Quoted product with Make and Mode	Technical compliance (Yes/No)	Deviations (if any)	Remarks (If any)
	detector shall be of low profile and fitted with dual status LED for 360 degree visual indication. The detector shall be UL listed.						
9	SITC of Response Indicator: It shall be compatible for all conventional 2 wire smoke/multi detectors. It shall be flush/ceiling mountable, fit with dual LED for 360 degree visibility. Alarm status shall indicated with steady Red colour LED.	Nos	4				
10	SITC of Single action Manual Pull station: It shall be made out of high quality non-toxic die cast. All components shall be pre painted or have plated surfaces to inhibit corrosion. It shall fit with pull down liver and 10 Amp/120VAC snap action switch complete as required.	Nos	2				
11	SITC of Sounder cum strobe: Sounder cum strobe shall designed for fire and security applications. It shall gives both audio and visual indication in case of fire. The horns shall be flush / ceiling mounted with /without back box. Xeon Flash tube Strobe light shall flash 60 times in a minute with 1Hz over entire operating voltage range. Horn output dB level shall be between 80 to 100 db in a meter distance. Horn cum strobe shall offer three different field configurable sound settings like ambulance sound, fire truck sound and police car sound complete as required	Nos	2				
12	SITC of Double action Manual Abort Switch: It shall be made out of high quality non-toxic die cast. All components shall be pre painted or have plated surfaces to inhibit corrosion. It shall fit with pull down liver (protected with a cover) and 10 Amp/120VAC snap action switch complete as required.	Nos	1				
13	SITC of Double action Manual Release Switch: It shall be made out of high quality non-toxic die cast. All components shall be pre	Nos	1				

Sno	Description	UOM	Approximate Qty	Quoted product with Make and Mode	Technical compliance (Yes/No)	Deviations (if any)	Remarks (If any)
	painted or have plated surfaces to inhibit corrosion. It shall fit with pull down liver (protected with a cover) and 10 Amp/120VAC snap action switch complete as required.						
14	Supply and laying of 2 core 1.5 sqmm stranded Copper, XLPE insulated, extruded FRLS PVC outer sheath, 600/1000V rated, BS5467/EN60228 complied, Armoured Fire alarm Red cable	Mtr	100				
15	Supply Installation Testing & commissioning of Mechanical foam type Fire Extinguisher with valve, initial fill, and horn complete with trolley.						
	4.5 Kg	Nos	2				
9	<b>BILL OF MATERIALS - RODENT REPELLENT SYSTEM</b>						
1	SITC of Rodent Controller: The Controller shall capable for auto/manual operation. It shall have a coverage area up to 6000 sqft with dedicated connection. Panel shall capable to connect up to 20 nos Transducers in dedicated line. The panel shall fit with 3 wave speed, 4 wave density and 4 frequency band operation. The panel shall be in all respect suitable for operation in 220V AC, 50 Hz power supply. Suitable MS wall mountable bracket also need to provide along with controller complete as required.	Nos	1				
2	SITC of Transducer: It shall be either ceiling or wall mountable type. It shall provide power output of 800mW and sound output of 80-110dB. The operating frequency shall be above 20 KHz and coverage area shall be upto 300 sqft in room void and 150 sqft in above ceiling/below false flooring.	Nos	6				
3	Supply and laying of 2 core 14/40 SWG Coated CT cable	Mtr	100				
4	Supply and fixing of 20 mm ISI Medium grade PVC rigid conduit along with all necessary fittings for	Mtr	30				

Sno	Description	UOM	Approximate Qty	Quoted product with Make and Mode	Technical compliance (Yes/No)	Deviations (if any)	Remarks (If any)
	the complete installation as required.						
<b>10</b>	<b>BILL OF MATERIALS - WATER LEAK DETECTION SYSTEM</b>						
1	SITC of 4 Zone WLD control panel: The controller shall designed to detect water leaks at localised points using the cable sensor. Panel shall be microcontroller based intelligent panel that are suitable for wall mounting inside AHUs, power distribution units or general areas where leak detection is required. They shall fitted as standard with LCD indication for healthy, fault & the water leak status. The external sounder shall be muted by simply pressing the mute button. It shall Monitor up to 200 meters of conductive fluid sensing cable. It shall configure upto 4 sensing zone. It shall Triggers individual Relay output for zone and activates common Fire & hooter relays.	Nos	1				
2	Supply and laying of 10 Mtr Water leak sensor cable: sensing cable shall used to reliably sense the presence of water or any conductive fluid. The sensing cable shall durable, easy to clean, fast drying, and able to resist damage from most contaminants. The cable shall constructed from nonconductive materials to help eliminate false alarms.	Nos	2				
3	Supply and laying of 10 Mtr Water leak sensor cable: sensing cable shall used to reliably sense the presence of water or any conductive fluid. The sensing cable shall durable, easy to clean, fast drying, and able to resist damage from most contaminants. The cable shall constructed from nonconductive materials to help eliminate false alarms.	Nos	2				

Sno	Description	UOM	Approximate Qty	Quoted product with Make and Mode	Technical compliance (Yes/No)	Deviations (if any)	Remarks (If any)
4	Supply and laying of 12 Mtr Water leak sensor cable: sensing cable shall used to reliably sense the presence of water or any conductive fluid. The sensing cable shall durable, easy to clean, fast drying, and able to resist damage from most contaminants. The cable shall constructed from nonconductive materials to help eliminate false alarms.	Nos	2				
5	SITC of Sounder cum strobe: Sounder cum strobe shall designed for fire and security applications. It shall gives both audio and visual indication in case of fire. The horns shall be flush / ceiling mounted with /without back box. Xeon Flash tube Strobe light shall flash 60 times in a minute with 1Hz over entire operating voltage range. Horn output dB level shall be between 80 to 100 db in a meter distance. Horn cum strobe shall offer three different field configurable sound settings like ambulance sound, fire truck sound and police car sound complete as required	Nos	1				
6	Supply and laying of 2 core 1 sqmm multistranded FRLS Copper cable	Mtr	30				
11	<b>BILL OF MATERIALS - IP BASED CCTV SURVEILLANCE SYSTEM</b>						
1	SITC of 8 Channel NVR: It shall supports up to 8 IP cameras with a maximum resolution of 8MP per channel. Recording shall supports various resolutions, including 8MP, 6MP, 5MP, 4MP, 3MP, 1080p, 720p, etc. Output resolution shall Supports up to 4K (3840 x 2160) at 30Hz. NVR shall support H.265+, H.265, H.264+, H.264 video decoding format. 1 SATA interface for hard drives, supporting up to 6TB storage. Incoming Bandwidth: Up to 80 Mbps. Outgoing Bandwidth: Up to 80 Mbps. 1 RJ-45 10/100/1000 Mbps Ethernet port	Nos	1				

Sno	Description	UOM	Approximate Qty	Quoted product with Make and Mode	Technical compliance (Yes/No)	Deviations (if any)	Remarks (If any)
	interface should be provided. It shall Supports video encryption for secure storage and transmission. It shall Supports user authentication and password protection for system access.						
2	SITC of 4MP IP Bullet Camera: 4MP fixed Bullet network camera designed for high-resolution surveillance applications. Image sensor shall be of 1/2.9" Progressive Scan CMOS. It shall support security features like Password protection, complicated password, HTTPS encryption, 802.1X authentication, watermark, basic and digest authentication for HTTP/HTTPS, WSSE and digest authentication for Open Network Video Interface, RTP/RTSP over HTTPS, security audit log, TLS 1.2, TLS 1.3, host authentication (MAC address). Camera shall have 1 nos RJ45 10 M/100 M self-adaptive Ethernet port, 12VDC coaxial power plug, PoE: IEEE 802.3af complied port. Day/Night operation, IR cut filter, IR upto 30 Mtr. It shall compatible with ONVIF protocol also.	Nos	7				
3	SITC of 2TB Surveillance Hard disk	Nos	1				
4	SITC of 32 inch LED Monitor	Nos	1				
5	SITC of 10 Mtr HDMI cable	Nos	1				
6	SITC of 6U Rack with PDU and Accessories	Nos	1				
7	SITC of 8 port PoE switch: Switch shall be wall/desk mountable. It shall have 8 x 10/100 Mbps PoE port, 1 x 10/100 Mbps RJ45 port. PoE power budget of the switch shall be min 60W. Switch shall support long distance transmission upto min 150 Mtr.	Nos	1				
8	Supply and laying of CAT6 UTP cable	Mtr	100				
9	Supply and fixing of 25 mm ISI Medium grade PVC rigid conduit along with all necessary fittings for the complete installation as	Mtr	50				



Sno	Description	UOM	Approximate Qty	Quoted product with Make and Mode	Technical compliance (Yes/No)	Deviations (if any)	Remarks (If any)
	required.						
<b>12</b>	<b>BILL OF MATERIALS - ACCESS CONTROL SYSTEM</b>						
1	<p>SITC of 4 Door Access Controller: The Controller shall be capable of controlling 4 doors, each with a proximity card reader as the "In" reader and an exit button for "Out" purposes. The panel shall support a card capacity of 30,000 users and a fingerprint capacity of 3,000 templates. The panel shall be equipped with a 32-bit CPU and 32 MB RAM, ensuring efficient and fast processing. The transaction storage capacity shall support a minimum of 100,000 access events. Communication options shall include TCP/IP for LAN/WAN connectivity RS485 for communication with access readers. The panel shall support standard Wiegand formats (26-bit, 34-bit, or custom) for reader integration. The panel shall feature 4 door sensor inputs for real-time door status monitoring, 4 lock relay outputs to control door locking mechanisms, 4 auxiliary relay outputs for alarm or other peripheral device integration. The panel shall include anti-tamper protection, generating alerts in case of unauthorized access or tampering. The system shall be compliant with CE, FCC, and RoHS standards. The System shall include necessary metal wall mountable enclosure along with battery backup if required.</p>	Nos	1				
2	<p>SITC of EM Proximity Card reader: The RFID readers shall be designed for integration with an access control system to provide seamless, secure, and user-friendly authentication. The readers must support proximity card technology and deliver reliable performance for indoor installations. The reader</p>	Nos	4				

Sno	Description	UOM	Approximate Qty	Quoted product with Make and Mode	Technical compliance (Yes/No)	Deviations (if any)	Remarks (If any)
	shall support reading 125 kHz proximity cards. The card reading range shall be up to 10 cm, ensuring user convenience. Communication between the reader and access control panel shall use the Wiegand protocol, supporting 26-bit and 34-bit formats. The reader shall include LED indicators (Red/Green) for visual status notifications and a buzzer for audio feedback. The reader's housing shall be made of durable materials (polycarbonate or equivalent) for long-term reliability. All mounting hardware must be provided.						
3	SITC of Exit Switch: The exit switch shall be designed for controlled door release in access control systems. It must be durable, easy to operate, and compatible with the access control panel to ensure reliable door exit functionality. The exit switch shall support NO/NC/COM (Normally Open/Normally Closed/Common) connections for flexible integration with various locking mechanisms. It shall be designed for use with 12V DC or equivalent power supply. It shall fit with a robust mechanical button for manual operation. The housing of the exit switch shall be made of durable materials such as stainless steel, aluminum alloy, or high-grade ABS plastic. The switch dimensions shall be compact and suitable for standard wall-mount installation. The device shall be designed for at least 500,000 cycles of operation, ensuring long service life.	Nos	2				
4	SITC of Emergency Door Release Switch: The emergency door release switch shall be designed to override access control systems in case of emergencies, allowing immediate and safe egress. The device shall be robust, reliable, and comply with safety standards to	Nos	3				

Sno	Description	UOM	Approximate Qty	Quoted product with Make and Mode	Technical compliance (Yes/No)	Deviations (if any)	Remarks (If any)
	ensure effective operation during critical situations. The emergency door release switch shall allow for manual activation to immediately cut power to electronic locks, enabling emergency exits. It shall support NO/NC/COM (Normally Open/Normally Closed/Common) connections for flexible integration with various door locking systems. The device shall operate with a standard 12V DC to 24V DC power supply. The switch shall be resettable manually (key reset or push reset type). The device shall include a glass panel that can be broken during emergencies. The emergency release switch shall support surface-mounted or flush-mounted installation. All necessary mounting hardware and installation instructions shall be included.						
5	SITC of Magnetic door contact sensor: It shall include a reed switch and a corresponding magnetic piece for operation. Normally Closed (NC) or Normally Open (NO), configurable as per the application. Operating Voltage: 12V DC or 24V DC, with low power consumption.	Nos	4				
7	SITC of Single door EM lock 600 lbs: The electromagnetic (EM) lock shall be designed for secure locking of single doors in access control systems. It shall operate using an electromagnetic holding force to ensure reliable door locking and provide fail-safe functionality for emergency situations. The EM lock shall provide a minimum holding force of 600 lbs (272 kg) to securely lock single doors. Fail-safe operation, 12VDC operation. It shall compatible with both in-swing and out-swing door configurations (with appropriate brackets). Housing Material shall be High-strength aluminum alloy with anodized or corrosion-resistant	Nos	4				

Sno	Description	UOM	Approximate Qty	Quoted product with Make and Mode	Technical compliance (Yes/No)	Deviations (if any)	Remarks (If any)
	finish. Armature Plate shall be Heavy-duty steel plate with anti-residual magnetism design to ensure proper release. 500,000+ locking/unlocking cycles to ensure durability. Installation kits, including L-brackets or U-brackets, shall be provided. Red/Green LED for lock status indication shall be provided.						
8	Supply of EM Proximity Card: The proximity card shall be a contactless access control credential designed to operate seamlessly with compatible access control readers. It shall provide secure, reliable, and convenient identification for authorized users. The card shall operate on 125 kHz frequency for proximity-based access control systems. The card shall be fully compatible with Wiegand and other standard access control formats. The card shall have a reading distance of up to 10 cm when used with a compatible reader. Each card shall have a unique pre-programmed ID. The card shall be made of durable PVC or equivalent plastic for long-term use. The card shall be designed for a minimum of 100,000 read cycles.	Nos	25				
9	Supply and laying of 8 core 0.5 sqmm multistranded, annealed tinned copper, screened Low voltage cable	Mtr	100				
10	Supply and laying of 2 core 1 sqmm multistranded FRLS Copper cable	Mtr	75				
11	Supply and fixing of 25 mm ISI Medium grade PVC rigid conduit along with all necessary fittings for the complete installation as required.	Mtr	50				
12	SITC of Access control Management software for 50 nos User ( Desktop PC Excluded)	Nos	1				

## Annexure -8

### Approved Make of Materials/Compliance (Also available in Excel format)

SR. NO.	ITEMS	APPROVED MAKES	VENDOR PROPOSED MAKES
<b>A</b>	<b>MAIN CAPITAL EQUIPMENTS</b>		
1	UPS	Vertiv / Schneider	
2	UPS Batteries	Exide / Amararaja/Panasonic	
3	Isolation Transformer	Krykad/Datsons	
4	Precision AC	Vertiv/ Schneider	
5	Split AC	Bluestar/Carrier/Daikin	
6	IT Equipment Racks	Netrack/Valrack / APW President / SelRack / Rittal	
<b>B</b>	<b>ELECTRICAL SYSTEMS</b>		
1	LV Panels & Switch Boards	CPRI Aproved Panel Makes	
2	MCB DB	Schneider / LK/Legrand/ABB	
3	Automatic Transfer Switches - ATS	Asco/ Socomec/LK/ABB/Elmeasure	
4	Changeover Switches - COS	Socomec/ LK/Legrand	
5	TVSS	ASCO/ Socomec/LK/OBO/ABB	
6	MCCB	ABB / Schneider / LK/Legrand	
7	MCB	ABB / Schneider / LK/Legrand	
8	Contactor	ABB / Schneider / LK/Legrand/Siemens	
9	Multifunction Energy meter	Schneider/LK	
10	Luminaries / lamps	Philips /Wipro/Crompton	
11	Switches/Sockets modular	Anchor/MDS/ Legrand/Havells/LK/Cabtree	
12	Industrial Plug & sockets	Schneider/ LK/Legrand/C&S	
13	PVC Conduits	Anchor/ BEC/ Power Flex/Precision/Balco/Toms	
14	Terminals	Wago / Phoenix / Elmex	
15	Cable termination lugs & Glands	Dowell / Comet / Joint Well/ Jainsons/ Hansel	
16	Cable tray	Profab/ Indiana/Hitech	
17	Wiremesh Cable Tray	CABLOFIL, OBO, ERICO/Legrand	
18	Fiber Raceway	COMSCOPE, PANDUIT/Molex/Norden	
19	Maintenance Free Earthing	Erico / OBO/ Any Approved Equivalent	
20	MS Conduit	Ancor/ BEC/ AKG	
21	LV flexible wires	KEI / Polycab/ Finolex / Havells/RR/Vguard	
22	LV power/control cables	KEI / Polycab/ Finolex / Havells/Gloster	
23	Telephone Wire / Cables	Delton/ Finolex/Polycab	
<b>C</b>	<b>CIVIL WORKS</b>		
1	False Floor	UNITILE or UNIFLAIR	
2	False ceilings	ARMSTRONG, INDIA GYPSUM or SAINTGOBAIN	
3	Fire Rated Door	Shakti Horman, MPP	

SR. NO.	ITEMS	APPROVED MAKES	VENDOR PROPOSED MAKES
4	Flush Doors	KITPLY, ANCH, INDIAN PLY AND WOOD CRAFTS	
5	Steel Doors, Windows and Ventilators	GODREJ, SEN HARVIK, AGEW	
6	Aluminum Doors and Windows	JINDAL	
7	Cement	ACC, Ultratech, Ambuja, Binani	
8	Gypsum Partition	ARMSTRONG, INDIA GYPSUM or SAINTGOBAIN	
9	Fire Retardant Paint	ASIAN PAINTS, Octagreen, VIPER, FIREPRO,	
10	Paints and Distemper	JENSON AND NICHOLSON, ASIAN PAINTS, SHALIMAR, GOODLAS NEROLAC, BERGER PAINTS /JOTUN	
11	Cement based paints	SUPER SNOWCEM, NITCOCEM	
12	Steel	SAIL / TISCO / RINL / JSW / Apollo / Vizag	
13	Mosaic tiles, terrazzo tiles (1st quality)	BHARAT, NITCO, NIMMCO	
14	Ceramic Tiles plain	NITCO, JHONSON, EURO & KAJARIA	
15	Water Proofing Compound	CICO, FOSROC, PIDILITE	
16	Plywood/Teak Particle Board	KITPLY, ANCH, MANGLAM	
17	Anti-Termite Oil to Joinery	Solignum, Woodguard, Ascu	
18	Hardware	ISI APPROVED AND MARKED MAKE SHALIMAR, CIEF	
19	Hardners	IRONITE, HARDONATE	
20	Door Closers, floor springs	HORMAN, DORMA,DMA, EVERITE, GARNISH	
21	GI pipes (Heavy grade, medium grade)	ZENITH, JINDAL, TATA	
22	GI Fitting (Malleable)	'R' Brand, KM	
23	Cast iron pipe	BIC/ HEP/ NECO	
<b>D</b>	<b>FIRE &amp; ELV SYSTEMS</b>		
<b>D1</b>	<b>FIRE ALARM SYSTEM</b>		
1	Fire Alarm Panel(s)	Simplex / Notifier / Edwards / Siemens	
2	Network Repeater with Fire Fighters Telephone System	Simplex / Notifier / Edwards / Siemens	
3	Graphic User Interface Software	Simplex / Notifier / Edwards / Siemens	
4	Smoke Detectors (Photo/PhotoThermal)	Simplex / Notifier / Edwards / Siemens	
5	Heat Detectors	Simplex / Notifier / Edwards / Siemens	
6	Duct Detector	Simplex / Notifier / Edwards / Siemens	
7	Interface Modules : Monitor / Relay / Control / Zone Monitor etc.	Simplex / Notifier / Edwards / Siemens	
8	Sounders / Sounder cum Flashers / Strobes / Annunciation devices	Simplex / Notifier / Edwards / Siemens	
9	Manual Pull Stations	Simplex / Notifier / Edwards / Siemens	
10	Fault Isolator Modules	Simplex / Notifier / Edwards / Siemens	

SR. NO.	ITEMS	APPROVED MAKES	VENDOR PROPOSED MAKES
11	Addressable Power Supplies	Simplex / Notifier / Edwards / Siemens	
12	Autodialler	ADT / GE / ATSS/Equivalent Preapproved.	
<b>D2</b>	<b>FIRE SUPPRESSION SYSTEM</b>		
1	Novec 1230 Gas	3M,USA/Siemens FK5112	
2	Cylinder with valve ( OEM Factory Filled) UL Listed and CCOE Approved	ANSUL / UTC/Siemens	
3	Electrical Actuator	ANSUL / UTC/Siemens	
4	Manual Actuator	ANSUL / UTC/Siemens	
5	Pneumatic Actuator	ANSUL / UTC/Siemens	
6	Discharge Hoses	ANSUL / UTC/Siemens	
7	Actuation Hoses	ANSUL / UTC/Siemens	
8	Manifold Check Valves	ANSUL / UTC/Siemens	
9	Nozzles	ANSUL / UTC/Siemens	
10	Low Pressure Switch	ANSUL / UTC/Siemens	
11	Nitrogen Pilot Cylinder and Valve Assembly & Pressure Guage	ANSUL / UTC/Siemens	
12	Discharge Pressure Switch	ANSUL / UTC/Siemens	
13	Piping ASTM A106 Gr. B Sch 40 & Sch.80	Jindal/ Indian Seamless / Maharashtra Seamless	
14	"UL Listed" Gas Release Panel, with programmable Relay Modules & Builtin Listed Power Supply	Notifier / Simplex/Secutron/Ravel	
15	"UL Listed" Dual Action Manual Release Station	Notifier / Simplex/Secutron/Ravel	
16	"UL Listed" Deadman type Abort Switch	Notifier / Simplex/Secutron/Ravel	
17	ABC type Fire Extinguishers	Safex / Minimax / Zenith / Firefite	
18	Mechanical Foam type Extinguishers	Safex / Minimax / Zenith / Firefite	
<b>D3</b>	<b>IP BASED CCTV SYSTEM</b>		
1	IP BASED CCTV CAMERA	DVTel / Pelco/ Honeywell	
2	Indoor PTZ CCTV CAMERA	DVTel / Pelco/ Honeywell	
3	IP CCTV software	DVTel / Pelco / Honeywell	
4	Video Analytics software	DVTel / Pelco / Honeywell	
5	(Miscellaneous Analytics Software, if required)	Iomniscient/ Delopt / Allgovision	
6	Server / PC / Monitors	HP / DELL / Pelco	
7	Professional CCTV Monitors	HP / SAMSUNG / PANASONIC/LG	
8	Managed LAN Network Switches	CISCO / NORTEL / HP	
9	Power Supplies	Transtech / Eqv Listed Power Supply	
<b>D4</b>	<b>ACCESS CONTROL SYSTEMS</b>		
1	Contact less Access Readers	HID/ESSL	

SR. NO.	ITEMS	APPROVED MAKES	VENDOR PROPOSED MAKES
	(Proximity)		
2	PIN type Readers	HID/ESSL	
3	Biometric Fingerprint Scanners	Bioscript / HID/ESSL	
4	Hand Geometry Readers	Ingersoll Rand/ESSL	
5	Access Controllers	Honeywell Prowatch / DDS / Schnieder/Siemens/ESSL	
6	Access Control Software	Honeywell Prowatch / DDS / Schnieder/Siemens/ESSL	
<b>D5</b>	<b>RODENT REPELLENT SYSTEM</b>		
1	Satellite Stations / Transducers	R Scat /Maser	
2	Rodent Repellant Controllers	R Scat /Maser	
<b>D6</b>	<b>WATER LEAK DETECTION SYSTEM</b>		
1	WLD Panel with LCD Display	Tracotech / Raymond / TTK/Csystems/Saini	
2	Distance Measuring type WLD Cable	Tracotech / Raymond / TTK/Csystems/Saini	
3	Digital Diversion Boxes, End Connectors	Tracotech / Raymond / TTK/Csystems/Saini	
<b>D7</b>	<b>CABLES AND CONTAINMENT</b>		
1	ISI Marked FRLS 2 core x 1.5 mm <sup>2</sup> , Multistrand Copper, FRLS Armoured cable, RED in Colour	Polycab/Finolex/Gloster	
2	FRLS 8c x 0.75 mm <sup>2</sup> multistranded copper, Shielded, PVC sheathed Armoured Cable	Polycab/Finolex/Gloster	
3	FRLS 4c x 0.75 mm <sup>2</sup> multistranded copper, PVC sheathed Armoured Cable	Polycab/Finolex/Gloster	
4	FRLS Cat-6e ,shielded, PVC sheathed Armoured Cable	Molex/Legrand/ Systamax/Panduit	
5	Armoured FRLS 2c x 1.0 mm <sup>2</sup> Cu, Multistranded, PVC sheathed Cables.	Polycab/Finolex/Gloster	
6	ISI Marked FRLS 2 core x 1.5 mm <sup>2</sup> , Multistrand Copper, Armoured cable	Polycab/Finolex/Gloster	
7	Signal cabling : Armoured FRLS Copper Flexible Conductor Shielded ( Aluminium Mylar tape with ATC Drain wire of 0.75 Sq. mm),PVC insulated,PVCS heathed Cable as per IS : 694 (2C, 3C, 4C, 8C x 1 sq mm)	Polycab/Finolex/Gloster	
8	Fiber Optic Cable	Systamax/Panduit/Kabletec	



SR. NO.	ITEMS	APPROVED MAKES	VENDOR PROPOSED MAKES
9	20 mm / 25 mm GI Conduit and Fiittings	BEC / Wimco / Universal	
10	Perforated GI Cable tray, Medium Duty	Hi Tech/ Profab / Right Engg / Sunrise / Adarsh	
11	GI Trunking	Hi Tech/ Profab / Right Engg / Sunrise / Adarsh	

## **Annexure -9**

**Attachment: Bill of Material in attached Excel Format - Price Schedule**

## **Annexure -10**

**Attachment: Civil Layout\_20250305-Proposed Layout.pdf**

## **Annexure -11**

**Attachment: Electrical Schematic\_20250305-Proposed SLD - Phase 1**